

PC 1025 PRO

操作手册

ZH EN

- ZH -	操作手册	2
- EN -	Operating manual	26



请扫码获取电子版说明书以及相关的视频（操作、维修等）。
Please scan QR-code to gain electric version manual and related videoes (operation/service etc.)

警告！

砂浆喷涂机会产生喷涂高压。

	注意-小心受伤！
①	<p>如果螺杆不动，千万不要将手探入螺杆中。挤伤危险。不得将物件或肢体伸入到料斗栅栏内。</p> <p>禁止将手或手指伸入喷射流内！</p> <p>禁止将喷枪对着自己或他人！</p> <p>涂料有腐蚀性和刺激性！</p> <p>保护好皮肤和眼睛！</p>
②	<p>每次启动前，必须遵守操作说明的要求，并遵循以下几点：</p> <ol style="list-style-type: none"> 1. 注意最大操作压力。 2. 检查所有连接件是否有泄漏。
③	<p>必须严格遵循本机定期清洁和维护说明的规定。</p> <p>操作本机和每次作业暂停前，必须遵循下列各点：</p> <ol style="list-style-type: none"> 1. 注意涂料固化时间。 2. 对喷枪和料管进行泄压。 3. 停止吸料泵。

确保安全！

目录

1 安全规定	4	10 常见故障排除	18
2 使用多功能螺杆泵PC 1025PRO 作业的简介	6	11 PC 1025PRO 备件清单	20
2.1 多功能螺杆泵PC 1025Pro 的功能	6	11.1 机架备件清单	21
2.2 可处理的材料	6	12 喷枪的备件清单	21
3 技术参数	6	13 PC 1025PRO 配件	22
4 PC 1025PRO 的说明示意图	7	设备试验	24
4.1 设备的操作元件和显示器	8	产品责任方面的重要信息	24
4.2 驱动装置	8	处置说明	24
4.3 压缩机 (配件)	9	瓦格纳尔建筑涂装标准质保条款	24
4.4 料管	9		
4.5 喷枪	9		
5 运输	10		
5.1 移动	10		
5.2 起重机运输 (图 4)	10		
5.3 汽车运输	10		
6 调试	10		
6.1 安装位置	10		
6.1.1 电源/延长电线的连接	10		
6.2 首次调试	10		
6.2.1 供货范围	10		
6.2.2 安装 (图 5)	11		
6.3 连接料管	11		
6.4 压缩机 (配件)	11		
6.5 连接喷枪 (图8)	12		
6.6 准备砂浆喷涂机 (图 9)	12		
6.6.1 预润滑料管	12		
6.7 喷涂过程的开始	13		
6.8 喷涂过程的结束	13		
7 有关应用技术方面的常规提示	13		
7.1 喷涂技术	13		
8 停用和清洁	14		
8.1 清洁料管	14		
8.2 设备清洁和更换胶套	14		
8.3 清洁喷枪	15		
8.4 空气滤清器 (配件)	15		
9 维护	16		
9.1 机械维护	16		
9.2 电气维护	16		
9.3 长期不使用	16		
9.4 轴密封圈 (图 14)	16		
9.5 密封件	17		
9.6 更换螺杆 (图 16)	17		

1 安全规定

下文对砂浆输送机的安全技术要求另行作出了规定：

- a) DIN EN 12001:2004-05, 混凝土和砂浆的输送、喷射和分配机 - 安全要求；德国版本 EN 12001:2003

您所在地区的所有适用的安全规定必须予以遵守。

为了安全使用砂浆喷涂机，必须特别注意下列提示：

砂浆喷涂机的用途

多功能螺杆泵PC 1025Pro 仅用于处理第 6 页中所描述的材料。**不得用于其他用途。**正确使用还包括遵守操作说明书和检查与维护条件。操作说明书必须始终妥善保管在砂浆喷涂机使用地点附近，以便能够随时查阅。

多功能螺杆泵PC 1025Pro 只允许和压力表一同投入运行。只允许使用制造商规定的料管。

仅使用标记了最小工作压力为 40 bar 的料管。

砂浆喷涂机仅供专业用户用于商业用途。

个人防护

为了保护眼睛、皮肤和呼吸道：请佩戴护目镜，穿防护服，戴工作手套，可能还需要涂抹护肤霜和戴呼吸防护用品。只要料管带有压力，则不得将其脱开。请注意压力表！戴护目镜！喷枪不得对准人员！

为了保护听力，请戴上耳塞。

运输机器以及使用机器作业的时候要戴上安全手套。

架设、安装或操作机器时不需要的人员必须远离机器。



PC 1025Pro 针对紧急情况配备了一个急停开关。

呼吸防护面具

为了保护工作人员不受矿尘的危害，需提供呼吸防护面具。

仅通过一个专用的馈电点和电源连接，例如：通过一个带故障电流保护装置 (INF ≤ 30 mA) 的施工用配电柜。

避免控制单元上用于远程操作的插口存在脏污现象。

	<p>喷射流会导致受伤危险。 每次开启机器前要检查喷枪上的材料开关是否关闭。 每次中断作业时都要将出料阀关闭。</p>
	<p>如果螺杆不动，千万不要将手探入螺杆中。挤伤危险。 不得将物件或肢体伸入到料斗栅栏内。</p>
	<p>绝对不要在螺杆未经保护或料斗已移除的情况下运行砂浆喷涂机。 如果蓄有长发，请千万小心。仅在穿戴紧身工作服的情况下工作。</p>

	<p>合上手柄，安装泵单元和连接材料软管时防止挤手。</p>
---	--------------------------------

清洁和维护

绝对不要在料管带有压力的情况下将其脱开，也不要不要在机器带有压力的情况下拆卸料管。注意压力表上的压力。

进行砂浆喷涂机维护作业的时候要始终将机器关闭，拔出电源插头，并防止意外接通。

不要用水射流、高压或蒸汽高压清洗机对砂浆喷涂机的电机和控制单元进行冲洗。渗入的水会导致的短路危险。

电气设备

仅由专业电工执行砂浆喷涂机电气设备作业。必须定期检查电气设备。诸如连接松动或电线烧焦之类的缺陷要立即加以排除。

保持砂浆喷涂机上的标签干净，并且清晰可读。

	<p>每次因机器原因停机或者故障停机时，都要立即将选择开关切换到位置“A”，以防止机器的意外重新运行。存在受伤危险。</p>
---	--

料管

	<p>注意因喷射导致的受伤危险！磨损、扭结和使用不当可能会导致料管破损。液体可能会穿过泄露点被喷射到皮肤上。</p>
---	--

每次使用前要彻底检查料管。

立即更换损坏的料管。

绝对不要自行修理损坏的料管！



避免料管严重弯曲或扭结，允许的最小弯曲半径为大约 80 cm。

车辆不得碾过料管，并要保护其不受锋利物体和棱边的影响。

绝对不能通过拉拽料管来移动机器。

不要扭转料管。

铺设料管的时候要确保不会有绊倒危险。

	<p>出于功能、安全和使用寿命方面的原因，必须使用 WAGNER 原装料管。</p>
	<p>如果使用废旧的料管则会增加损坏的风险。 Wagner 建议，每6年必须更换料管。</p>

架设在不平整的地方

必须如图所示放置砂浆喷涂机，这样才能够避免机器滑动。用制动器刹住前轮。

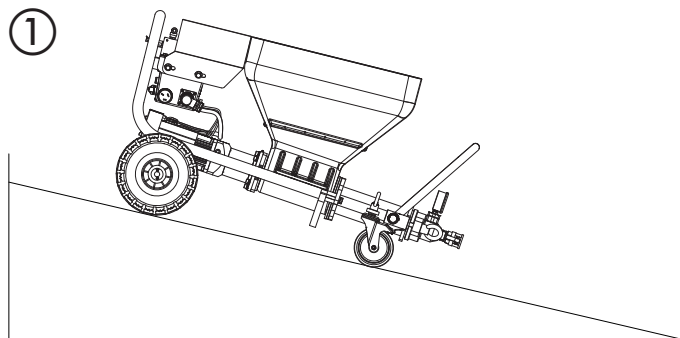

2 使用多功能螺杆泵PC 1025PRO 作业的简介

多功能螺杆泵PC 1025Pro 专门用于使用和处理已混合好的矿物材料而设计。

PC 1025Pro应用范围广泛，包括：住宅建筑、商业建筑、新农村建设、防火工程、防腐工程、防水工程、灌浆工程、加固工程等。

该机器并非设计用作清洗设备。

2.1 多功能螺杆泵PC 1025PRO 的功能

通过料斗供应材料。进料轴将材料输送到偏心螺杆泵。通过料管，该螺杆泵会建立输送所需的压力。向喷枪输送雾化所需要的压缩空气。通过电气控制系统可以开启和关闭砂浆喷涂机或者调节输送量。

通过无级可调的材料输送量可以获得平稳、均匀的喷涂图案。

2.2 可处理的材料

- 真石漆
- 腻子（含沙腻子、外墙含纤维腻子等）
- 保温复合系统粘结剂（矿物和合成树脂系统）
- 合成树脂灰浆
- 硅酸盐灰浆
- 有机硅树脂灰浆
- 矿物涂层灰浆
- 轻型灰浆系统
- 刮涂灰浆
- 保温砂浆
- 混合砂浆
- 多孔混凝土涂料
- 石英塑料
- 屋面涂料
- 阻燃性涂料
- 矿物密封性泥浆
- 沥青乳化液
- 液态粗纤维
- 灌浆砂浆
- 合成树脂底漆
- 粘附性底漆
- 填充涂料，也包括含纤维型
- 弹性涂料
- 合成树脂型吸音灰浆
- 合成树脂型油灰

注：

- 最大颗粒不超过6mm
- 由于各个厂家材料存在一定差异，选购前请务必参考材料厂家提供的材料安全数据表MSDS，或咨询瓦格纳尔签约经销商或者瓦格纳尔服务热线400-6118-808。

3 技术参数

	PC 1025Pro
电压：	230 V ~, 50 Hz
保险丝：	16 A 慢熔断
设备连接线：	5 m 长, 3 x 2.5 mm ²
电机功率 P ₁ ：	2.3 kW
最大输送量（水）：	10, 15, 20 l / min (根据螺杆/胶套)
最大工作压力：	40 bar
最大粒度：	6 mm
尺寸：长 x 宽 x 高：	1150 x 520 x 610 mm
料斗容量：	50 升
重量 (PC 1025Pro)：	59 kg
重量（喷枪）：	1,0 kg
最大轮胎压力：	2.0 bar
防护等级：	IP 54
最大声压级：	70 dB (A)*
雾化空气接口：	快插接头 DN 7.2 mm
最大雾化空气压力：	10 bar
最低空气流量：	320 l/min
料管的最大长度：	40 m (和 2.5 m 鞭管)
最大输送高度：	20 m

* 测量位置：距设备1米，且高于地面1.6米，混响地面。

4 PC 1025PRO 的说明示意图

- | | |
|-----------------|---------------|
| 1 喷枪压缩空气软管接口 | 2 空压机气源接口 |
| 3 控制器 | 4 控制器操作面板 |
| 5 红色故障指示灯 | 6 绿色电源指示灯 |
| 7 急停开关 | 8 料斗 |
| 9 压力表 | 10 带螺杆的出口单元 |
| 11 料管接头 | 12 料管组件 (含气管) |
| 13 喷枪 | 14 气动开关控制信号接口 |
| 15 油水分离器 (可选附件) | |

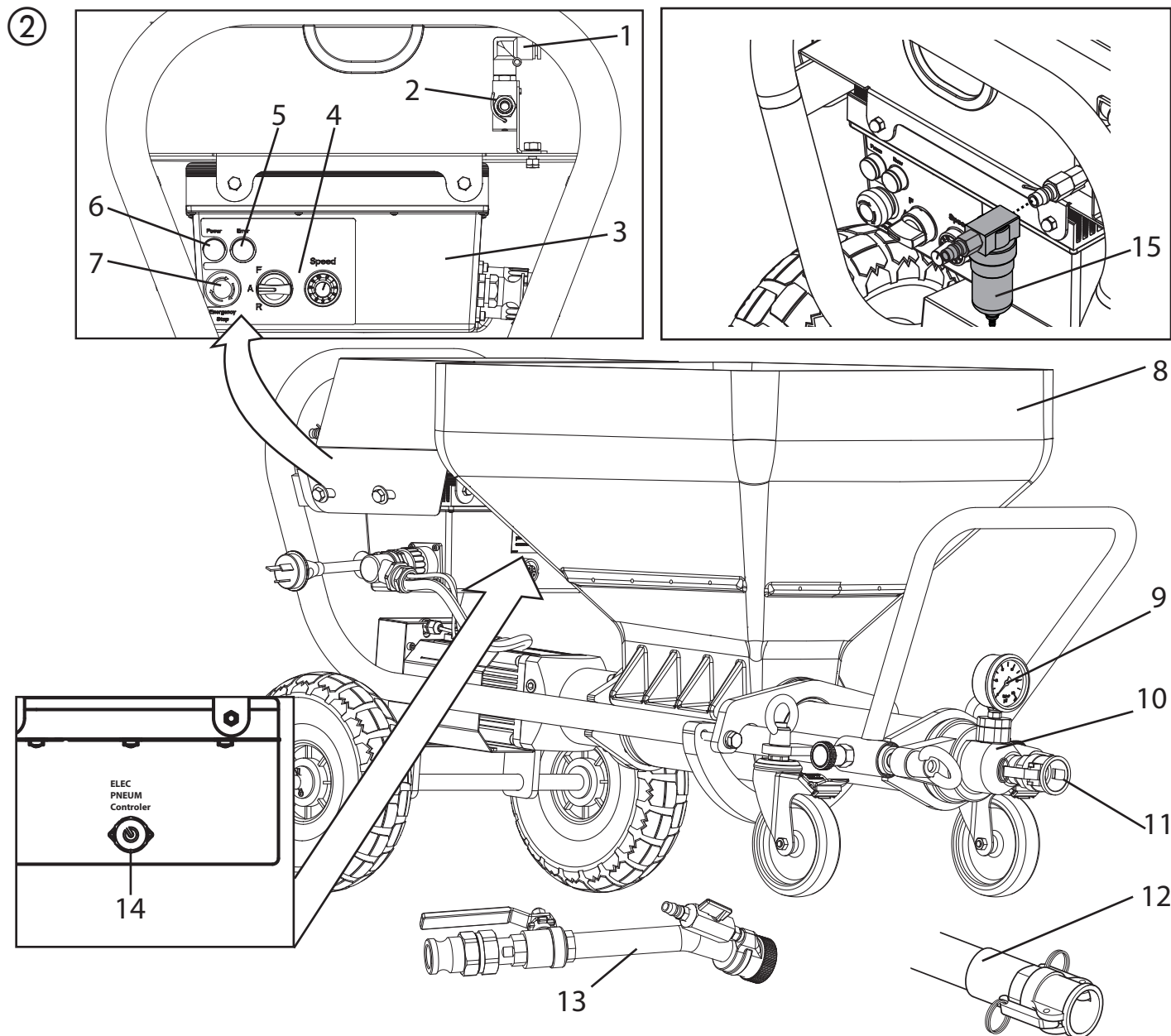

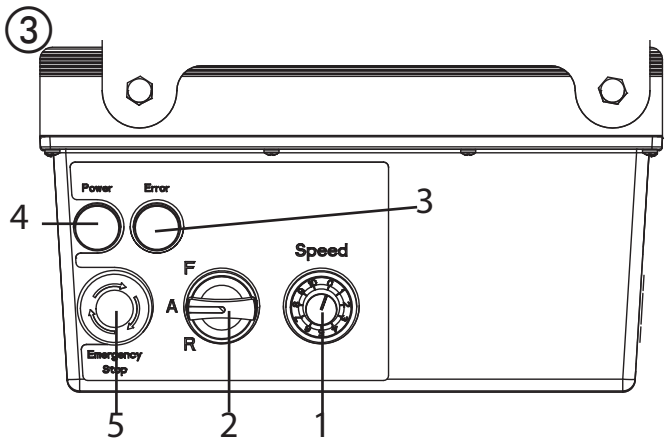

4.1 设备的操作元件和显示器

- 1 转速调节器 0-10
- 2 工作模式的旋转开关
- 3 指示灯（故障）
- 4 运行提示灯（电源）
- 5 急停开关



通过转速调节器（图 3.1），输送量为 0-10 级无级可调。

通过选择开关（图 3.2）可选择以下设置：

	位置“A”= 自动 通过气动喷枪进行控制的基础设定
	位置“F”= 手动开启 开启砂浆喷涂机。 以下情况需要进行该项设置： <ul style="list-style-type: none">• 拆卸泵单元• 对料管进行预润滑，以改善材料的流动能力• 清洁
	位置“R”= 倒档。 以下情况需要进行该项设置： <ul style="list-style-type: none">• 安装胶套• 手动泄压

选择开关使用方面的详细说明：

如果选择开关被切换到位置“A”，则可以通过气动喷枪上的空气量调节器开启和关闭 PC 1025Pro。

针对未装有任何喷枪的情况（例如：安装/拆卸泵单元），切换到开关位置“F”开启机器，切换到位置“A”则关闭机器。



重要：通过选择开关和出料阀都是可以进行控制的。可随时从位置“A”（通过出料阀控制）切换到位置“F”。故设备可实现单人操作。

运行指示灯（绿色，图 3.4）表示存在电压，并且运行准备就绪。

插入电源后，指示灯（红色，图 3.3）闪烁，表示 PC 1025Pro 在系统自检。如果一切正常，则红色指示灯会在大约 30 秒后不再闪烁。运行期间只要存在故障，则红色指示灯亮起。有关故障类型方面的详细信息请参见第 18 页的“故障排除”章节。



如果插入电源插头时选择开关位于位置“F”，则设备不会开启。
快速将选择开关切换到位置“A”，然后再切换到位置“F”，开启设备。

急停开关

按下急停开关会立即将 PC 1025Pro 关闭。
为了重新解除急停开关的锁定，必须旋转急停开关。解除急停开关锁定后，机器仍然处于关闭状态。为了重新开启机器，必须快速将选择开关切换到“A”，然后将其切换到“F”。

4.2 驱动装置

如果发生了过载情况，则砂浆喷涂机的驱动装置会自动关闭（红色指示灯亮起）。
将选择开关（图 3.2）切换到位置“A”，并拔出电源插头。将转速调节器（图 3.1）切换到位置“0”。
等待大约 5 分钟，然后重新插入电源接头，并开启砂浆喷涂机。设定所需的输送量。



运行期间驱动单元会稍微发热。
这是正常的，并不是功能故障的征兆。

4.3 压缩机 (配件)

VKM 592 进气容积 590 l/min

提示:

压缩机必须按照随附的操作说明书进行操作。

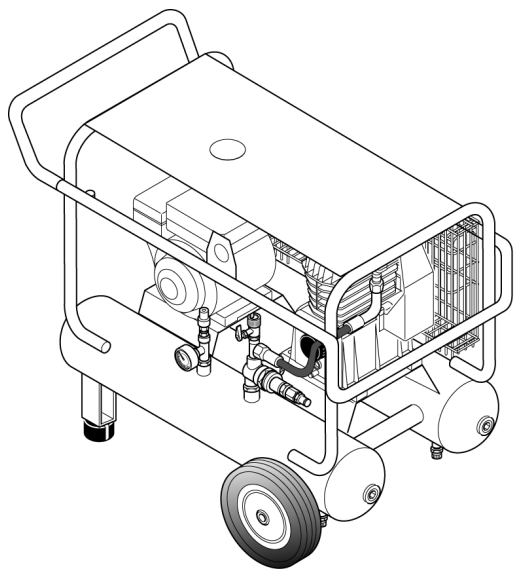

C330 进气容积 330 l/min

提示:

压缩机必须按照随附的操作说明书进行操作。

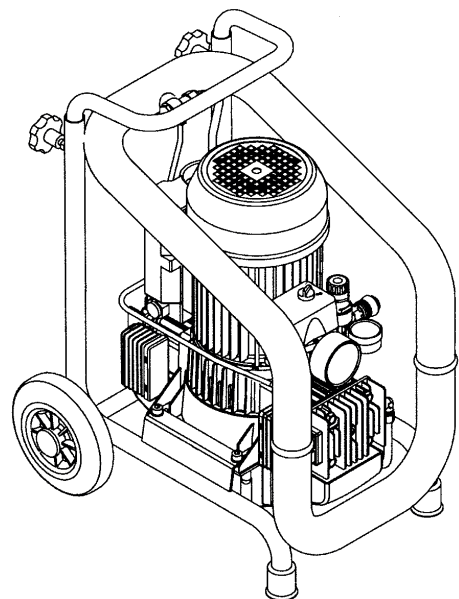

4.4 料管

- 1 材料接口 - 砂浆喷涂机
- 2 雾化空气接口-压缩空气气源
- 3 材料接口 - 喷枪
- 4 料管
- 5 雾化空气接口 - 喷枪

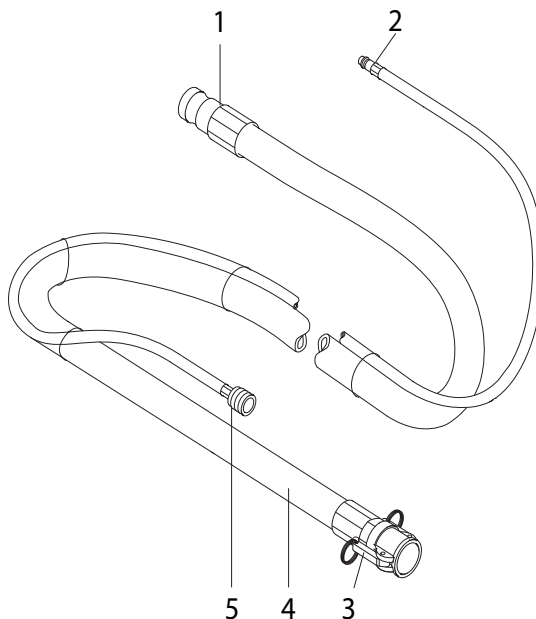

4.5 喷枪

- 1 材料接口
- 2 物料阀:
打开: 物料阀朝后
已关闭: 出料阀和喷枪呈 90°角度
- 3 纹理喷嘴:
喷枪中可装入不同的纹理喷嘴。喷嘴大小视材料粒度和所需喷涂图案而定。
- 4 空气阀 (开启和关闭机器)
- 5 雾化空气接口

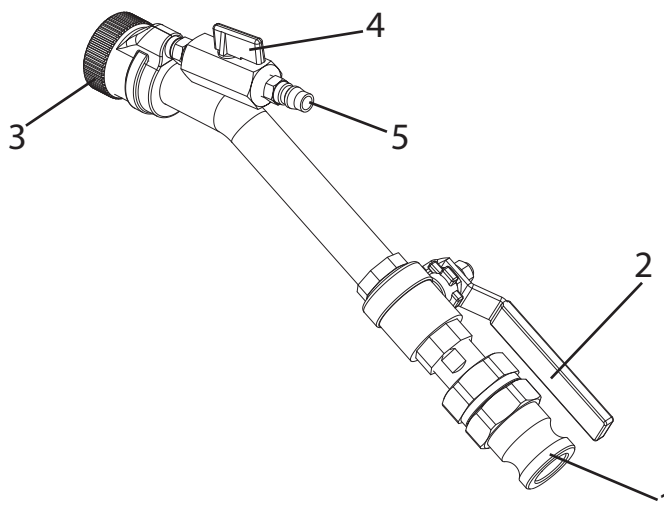

5 运输

5.1 移动

将电源线盘绕在手柄上，并移除软管。
将喷嘴和其他小物件堆放在工作台内。
在手柄上推动或拉动 PC 1025Pro。

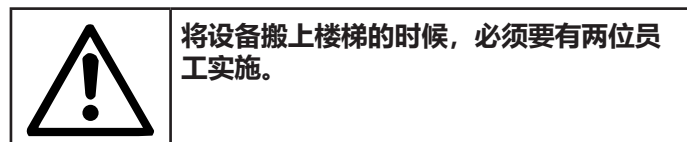

5.2 起重机运输 (图 4)

吊带或吊索（不是钢丝绳）的吊点请参见示意图。

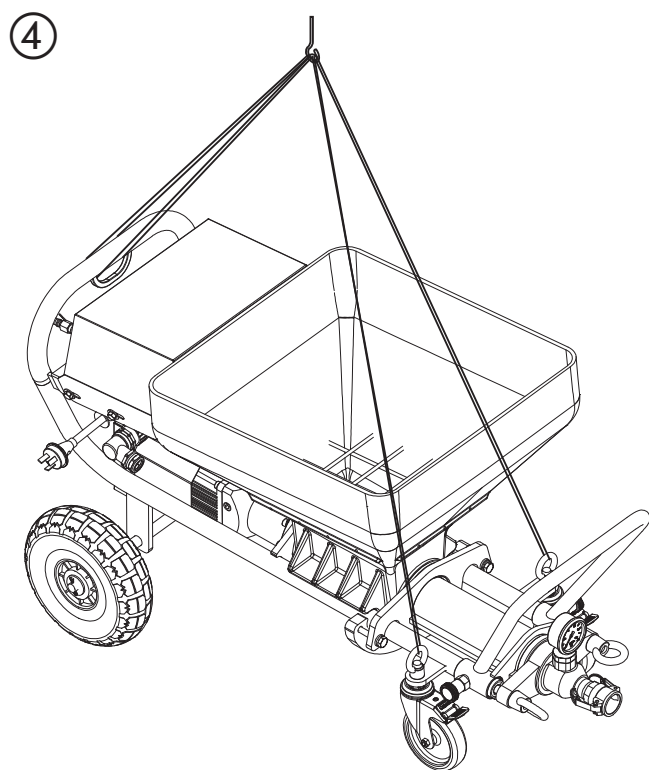

5.3 汽车运输

设备要用合适的固定工具固定在汽车内。

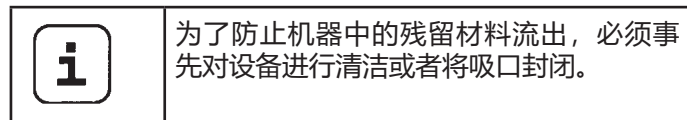

6 调试

6.1 安装位置

砂浆喷涂机要架设在平整的地方，以避免打滑。

6.1.1 电源/延长电线的连接

仅通过一个专用的馈电点和电源连接，例如：通过一个带故障电流保护装置 ($INF \leq 30 \text{ mA}$) 的施工用配电柜。

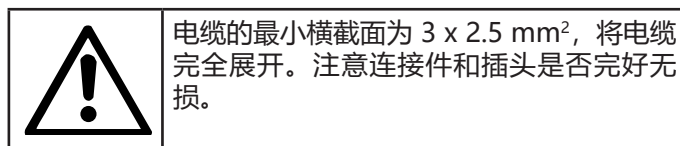
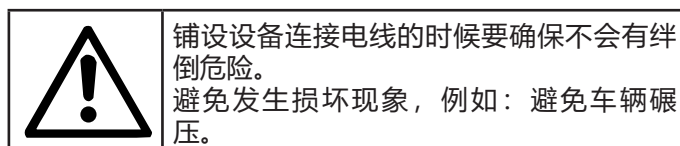

- 和电源连接前要注意，电源电压是否和功率标牌上的说明一致。

6.2 首次调试

6.2.1 供货范围

制造商为该机器提供了以下单独的零部件：

- 整套基础设备，包括驱动单元、控制单元、料斗和带轮子的运输用框架
- 转子和定子
- 料管
- 喷枪
- 喷嘴、喷嘴清洁器和清洁球（2 件）

6.2.2 安装 (图 5)



拔掉外部控制系统。仅允许负责机器控制的工作人员进行安装。绝对不要在螺杆未经保护的情况下运行砂浆喷涂机。如果螺杆不动，千万不要将手探入螺杆中。挤伤危险。如果蓄有长发，请千万小心。仅在穿戴紧身工作服的情况下工作。

松开环形螺丝 (1)，并移除出口单元 (2)。
然后用合适的泵润滑剂喷涂胶套 (3) 和螺杆 (4) (订购编号 9992 824)。
将选择开关 (6) 切换到位置 “A”，并将转速调节器 (7) 切换到位置 “0”。
将电源插头和电源连接。
运行指示灯 (8) 显示运行准备就绪。
功能检查期间红色指示灯 (9) 闪烁大约 30 秒。
将转速调节器 (7) 切换到位置 1 或 2。
将胶套 (3) 推到螺杆 (4) 的顶端上 (注意导轨 (5))。
将选择开关 (6) 切换到 “R”，使胶套自动拉上螺杆。
只要胶套到达了终点位置，便要将选择开关 (6) 切换至 “A”。
重新安装出口单元 (2)，并用环形螺丝 (1) 拧紧。

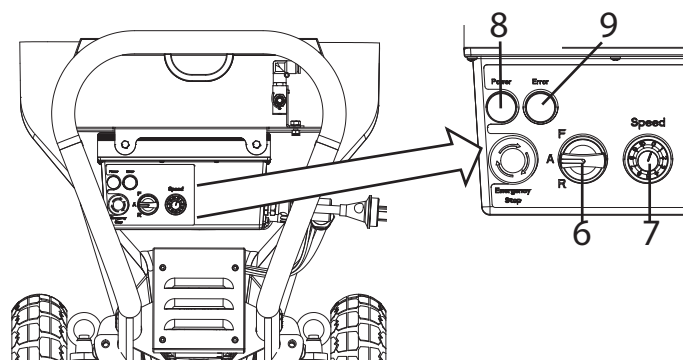
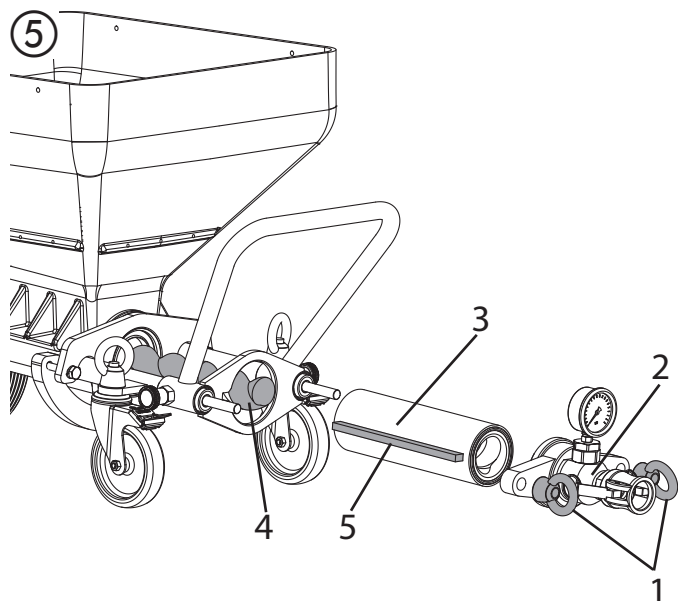

6.3 连接料管

- 检查泵单元是否牢固。
- 检查出口单元内的密封件 (图 6、1)。
- 连接料管 (图 6.2)，并通过拉紧杆 (3) 进行固定。
- 将料管的雾化空气接口与流量开关的前部接口 (图 7、1) 连接，并将压缩机空气软管 (配件) 与流量开关的后部接口 (图 7.2) 连接。

6.4 压缩机 (配件)

压缩机要放在砂浆喷涂机旁安全的地方，并和电源连接。

提示：

压缩机必须按照随附的操作说明书进行操作。

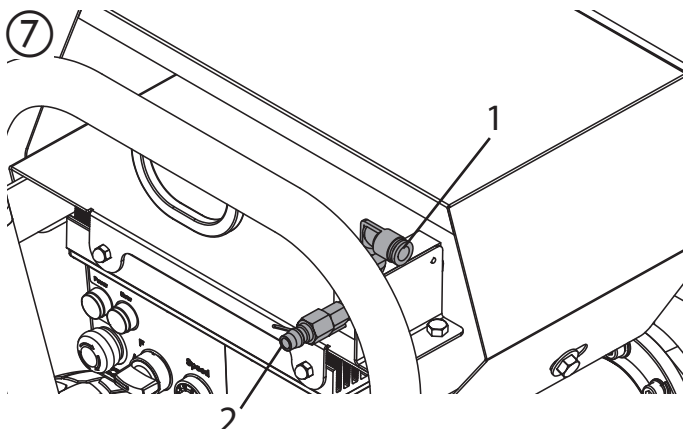
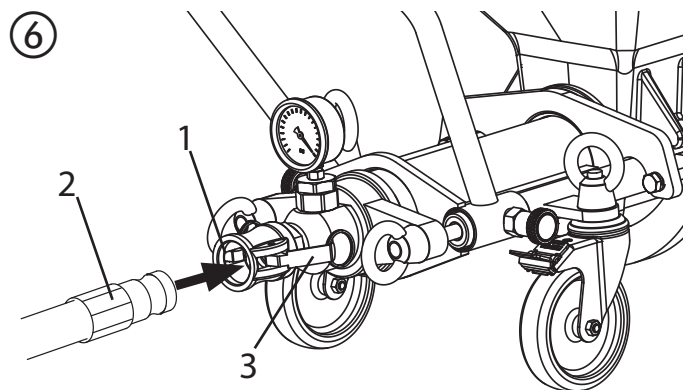

调试

6.5 连接喷枪 (图8)

- 请为材料选择合适的喷嘴：
喷嘴大小至少要是材料粒径的三倍，例如：
合成树脂灰浆粒度 → 3 mm
喷嘴大小 → 10 mm
- 将喷嘴的锥形口朝向喷枪头安装到喷枪中
- 喷枪 (2) 和材料软管 连接，并用拉紧杆 (3) 固定。
- 关上出料阀 (4)。(出料阀朝前)。
- 将雾化空气接口 (5) 和料管的空气软管连接。
- 将选择开关切换到位置 “A”。

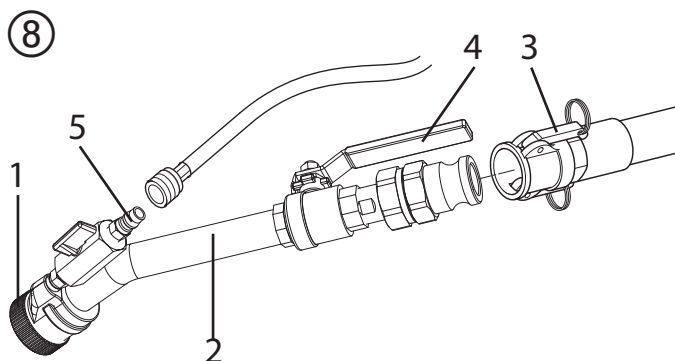

6.6 准备砂浆喷涂机 (图 9)

建议用于砂浆喷涂机的润滑剂

	<p>水不足以成为润滑剂。 小心堵塞！ 使用纤维素胶（如美德兰墙纸胶，商品编号 2312136）</p>
--	--

- 将 2-3 升 的纤维素胶灌入料斗中。
- 将砂浆喷涂机和 电源连接。
运行指示灯 (1) 显示运行准备就绪。

	<p>每次开启之前检查喷枪的空气量调节器和物料阀是否已经关闭（物料阀和喷枪呈 90° 角度） 每次中断作业时，必须关闭空气量调节器和物料阀。</p>
--	--

- 将选择开关 (2) 切换到位置 “F”。
- 将转速调节器 (3) 切换到位置 “3”。

	<p>料管不得扭结！ 要防止料管损坏，例如：被车辆碾压以及尖锐的物体和棱边。</p>
--	--

- 将喷枪放在空桶上方。
- 打开喷枪上的出料阀 (图 10.1) (物料阀朝后)，砂浆喷涂机开启。
- 如果有纤维素胶从喷嘴流出，即可将出料阀 (图 10.1) 关上 (物料阀和喷枪呈 90° 角度)。
- 将材料灌入料斗中。

	<p>如使用矿物基材料。只能将料斗加注到半满状态。</p>
--	-------------------------------

- 将喷枪重新放在空桶上方。
 - 打开喷枪上的出料阀 (图 10.1)。
 - 只要有材料从喷枪中流出，即可将出料阀 (图 10.1) 关上。
 - 将选择开关 (图 9. 2) 切换到位置 “A”。
- 现在便可以对砂浆喷涂机进行加料，并且机器已经运行准备就绪。

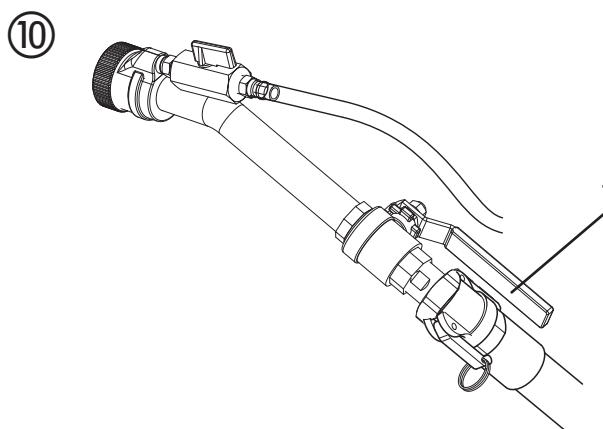
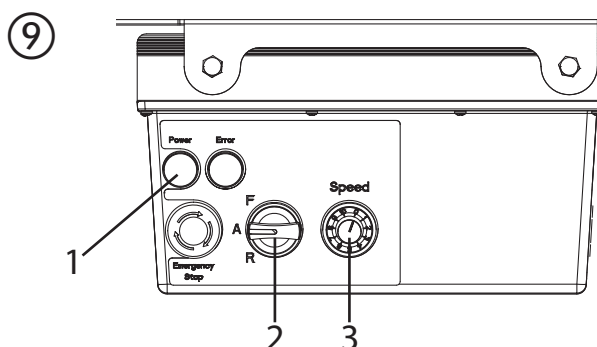

6.7 喷涂过程的开始

- 打开喷枪上的空气阀 (图 11.3) 和出料阀 (图 11.1)。
- 材料量要通过控制单元的转速调节器 (图 11.2)，空气阀 (图 11.3) 开度则要根据喷涂图案 进行相应的调节。



重要：不得空运行砂浆喷涂机。如果不再 有材料从喷嘴流出，或者喷射射流不在具 有规律，则要立即关闭设备。可能的原因 和问题排除方法请参见“故障排除”章 节。



不能通过出料阀调节出料量，会导致出料 阀过早磨损，只能够通过转速调节器进行 调节。

6.8 喷涂过程的结束

- 关闭出料阀 (图 11.1)
- 关闭空气阀 (图 11.3)。



喷涂过程结束时始终要将出料阀关上。

⑪

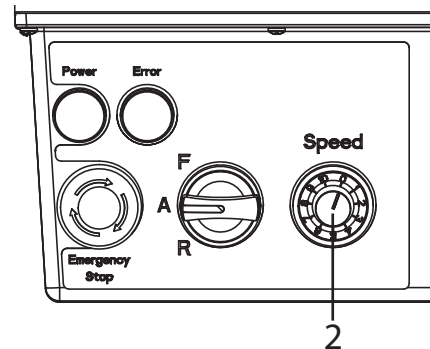
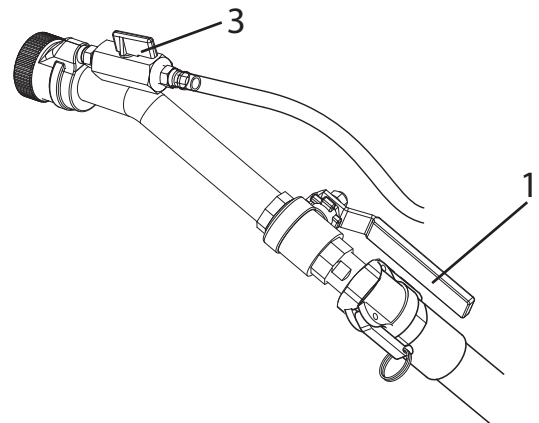

7 有关应用技术方面的常规提示

7.1 喷涂技术

喷涂期间，喷枪要始终和目标物保持 30 - 60 cm 的距离。如果不遵守该项规定，可能会导致喷涂图案不规则。喷涂图案取决于材料、粘度、喷嘴大小、输送量和雾化空气量。

示例：

- 平整表面** → 较大的雾化空气量
- 粗糙表面** → 较小的雾化空气量
- 较大的输送量** → 较大的雾化空气量

在试样表面对所需的结构进行测试。喷射射流的侧面边界不要太过明显，故此要对喷枪和目标物之间的距离进行正确的选择。喷雾边缘应缓慢过度，以便下一涂层的搭接。如果喷枪始终是平行移动的，而且和目标物呈 90°角度，则会产生最少的喷雾。

提示：

如果涂料里颗粒的棱边较为锋利，则会导致泵、料管、出料阀和喷嘴产生较为严重的磨损。



在脚手架上处理料管的时候，始终要从脚 手架外侧导入软管，这种方法优点已充分 得到测试验证。

8 停用和清洁



不得对砂浆喷涂机的电机和控制单元进行水洗清洁。首先肯定不能用水射流、高压或蒸汽高压清洗机进行冲洗。渗入的水会导致短路危险。

8.1 清洁料管

- 将料斗泵空。



重要：不得空运行砂浆喷涂机。如果不再有材料从喷嘴流出，或者喷射射流不规律，则要立即关闭设备。可能的原因和问题排除方法请参见“故障排除”章节。

- 关闭砂浆喷涂机和压缩机。
- 关上出料阀。
- 将纹理喷嘴从喷枪中移除，并进行清洁。
- 在料斗中灌水，并将喷枪放在空桶上方。
重要：不得空运行砂浆喷涂机。清洁期间要始终在料斗中补充注入足量的水。
- 将转速调节器切换到位置“5”
- 将选择开关切换到位置“F”。
- 打开出料阀。
- 将材料从软管泵入空桶中，直至流出的材料仅呈稀液状。
- 关上出料阀。
- 将选择开关切换到位置“A”。



料管必须不带有任何压力。
快速将转向开关切换到位置“R”（反向）。
注意压力表 → 0 bar。
戴护目镜。

- 将料管和泵单元脱开连接。
- 将喷枪和料管脱开连接。
- 将清洁球放入到料管，并重新连上料管。
- 将选择开关切换到位置“F”。
- 几秒钟后，清洁球会从喷枪中排出。
- 视材料情况，重复清洁过程 3 - 4 遍



料管必须不带有任何压力。
快速将转向开关切换到位置“R”（反向）。
注意压力表 → 0 bar。
戴护目镜。

- 将选择开关切换到位置“A”。
- 将料管和泵单元脱开连接



还有使用清洁适配器（配件）进行清洁的其他方法。
该清洁适配器可以通过爪式联轴器和水管或水龙头连接。
将清洁球插入料管中，将料管和清洁适配器连接，并用水彻底冲洗。

8.2 设备清洁和更换胶套

- 对多功能螺杆泵进行清洁。
为此，要在泵中通入适当的泵润滑剂或者混合了餐具洗涤剂的水。

拆卸



砂浆喷涂机必须不带有任何压力。
快速将转向开关切换到位置“R”（反向）。
注意压力表 → 0 bar。
戴护目镜。



拔掉外部控制系统。仅允许负责机器控制的工作人员拆卸泵单元。绝对不要在螺杆未经保护的情况下运行砂浆喷涂机。如果螺杆不动，千万不要将手探入螺杆中。挤伤危险。如果蓄有长发，请千万小心。仅在穿戴紧身工作服的情况下工作。

- 将选择开关（图 12.1）切换到位置“A”，并将转速调节器（2）切换到位置“0”。
- 拔出电源插头。
- 松开环形螺丝（3），并移除出口单元（4）。
- 将转速调节器（2）切换到位置1或2。
- 将电源插头和电源连接。
- 将选择开关（1）切换至位置“F”。当胶套（5）从螺杆（6）松开时，将选择开关切换至“A”。
- 完全取下胶套（5）。
- 拔出电源插头。

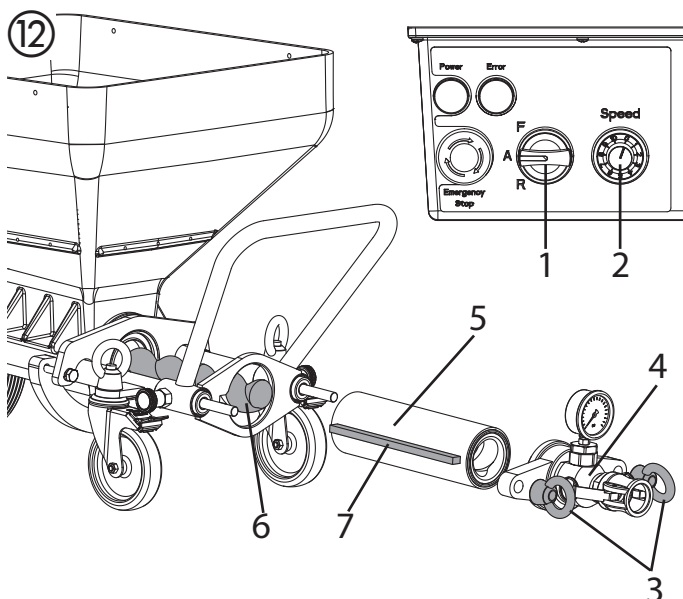

清洗出口单元

用水射流和合适的瓶刷对出口单元 (4) 进行清洁。
用水射流和合适的刷子对料斗 (7) 进行清洁。
用散热片专用刷子对防护格栅进行清洁。
螺杆 (6) 和胶套 (5) 同样需要清洁。
然后用合适的泵润滑剂喷涂螺杆 (6) 和胶套 (5)。
泵外壳和泵管的螺纹要保持清洁干净，这样可以避免组装后出现泄漏。

组装

	<p>短时间停机时，可将胶套固定在螺杆上。 如果长时间存放，请务必将螺杆从设备上拆卸下来。</p>
---	---

有关安装请见章节 6.2.2

8.3 清洁喷枪

- 清洁纹理喷嘴
- 用清洁通针清洁喷嘴气孔。
- 用瓶刷 (0342 329) 清洁喷枪 和材料管 内部。
- 彻底清洁所有螺纹
- 用清水彻底冲洗喷枪。开和关出料阀三次。

8.4 空气滤清器 (配件)

- 移除空气软管。
- 拧出过滤器外壳 (6) 上的过滤器盖 (1) (注意不要遗失组件 2-5)。
- 检查过滤器 (3) 并在必要时使用温皂液清洁或更换。
- 将过滤器外壳 (6) 转动 180°。
- 重新装入所有组件，然后再将过滤器盖 (1) 拧入过滤器外壳中。
- 将过滤器外壳拧回初始位置。

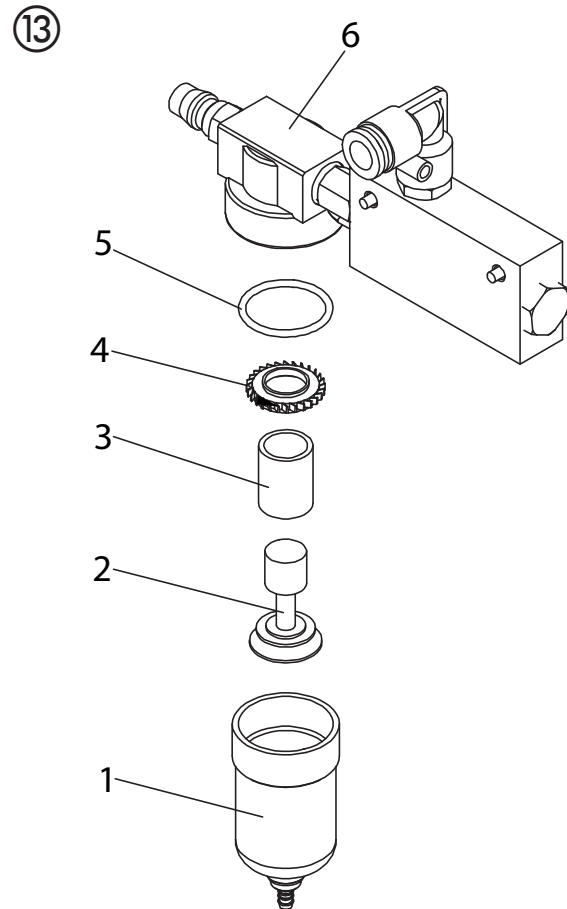

9 维护

	<p>注意！ 进行所有维护作业前务必要通过拔出电源插头来切断机器供电，否则会存在短路的风险！</p> <p>仅允许具有相关资质的人员进行维修。该设备每次维修后都要由一名电工进行检查。</p>
--	--

在设计砂浆喷涂机的时候确保了将保养和维护作业的量将至最低。但是，仍然要定期执行以下作业任务并对零部件进行检查：

9.1 机械维护

- 泵管和泵外壳的螺纹要保持清洁干净和密封
- 所有联轴器和连接件的密封件都必须进行密封性检查。必要时更换磨损的密封件
- 每次运行前都要检查是否损坏：
 - 料管
 - 电源线
 - 控制单元

9.2 电气维护

- 电气驱动装置及其通风口必须始终保持清洁干净，并且不允许用水进行清洁。**短路危险**

9.3 长期不使用

如果较长时间不使用砂浆喷涂机，则要彻底对其进行清洁和防腐蚀保护。

	<p>将胶套从泵单元中取出，这样的话胶套便不会和螺杆咬死。</p>
---	-----------------------------------

9.4 轴密封圈 (图 14)

	<p>注意！ 被弄脏的轴封可能造成驱动装置严重损坏。每次使用后检查并清洁轴封。500 个运行小时后或每年更换一次油封。</p>
---	--

- 检查轴封 (1)，并用提供的瓶刷彻底清洁。

	<p>如果轴封损坏或无法正确清洁，请联系 Wagner 服务部门。因清洁不充分造成的损坏不在保修范围内。</p>
---	--

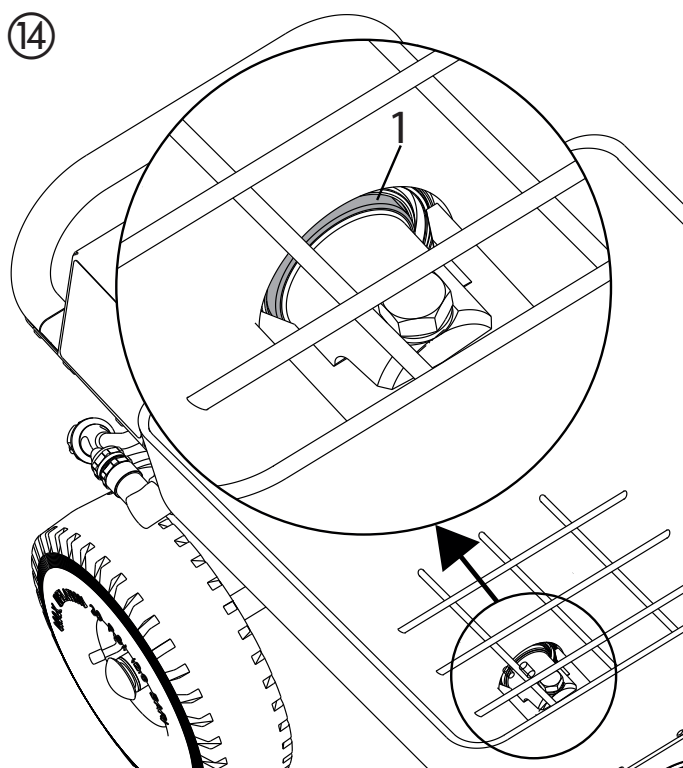

9.5 密封件



每月检查 PC 1025Pro 中的密封件。

- 将选择开关 (图 15.1) 切换到位置 “A”，并将转速调节器 (2) 切换到位置 “0”。
- **拔出电源插头。**
- 松开环形螺丝 (3)，并移除出口单元 (4)。
- 将转速调节器 (2) 切换到位置 1 或 2。
- **将电源插头和电源连接。**
- 将选择开关 (1) 切换至位置 “F”。当胶套 (5) 从螺杆 (6) 松开时，将选择开关切换至 “A”。
- 完全取下胶套 (5)。
- **拔出电源插头。**
- 拔出两个锁销 (7) 并取下胶套止动器 (8)。
- 用 17 号扳手拧松并取下法兰 (9)。
- 取下料斗 (10)。
- 检查密封件 (11,12)，必要时进行更换。
- 检查胶套 (6)，必要时进行更换 (参见章节 9.6)。

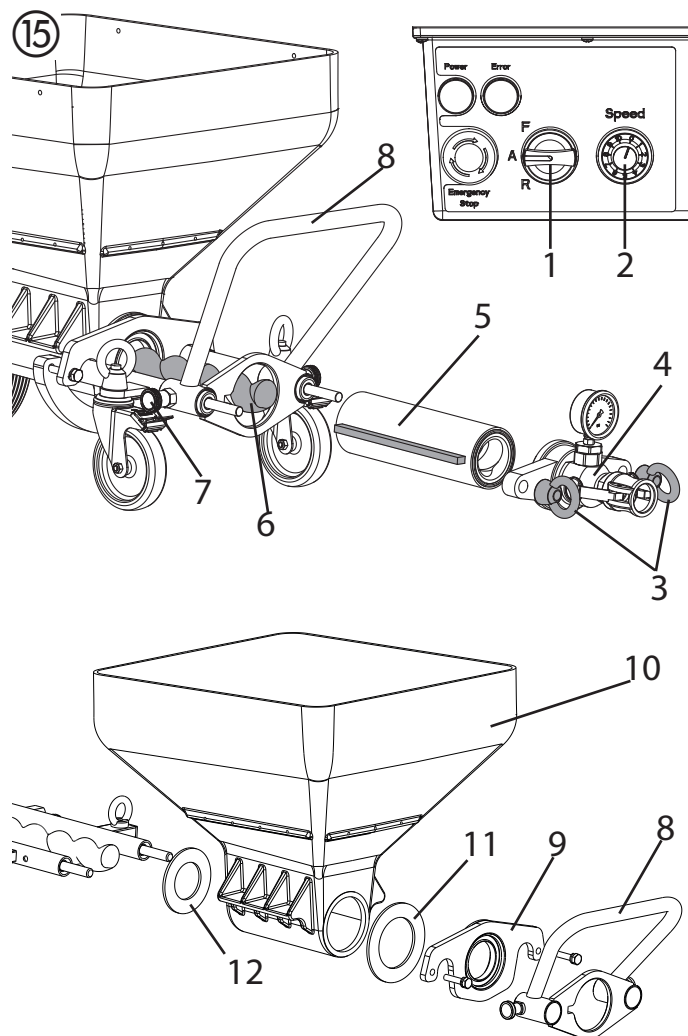

9.6 更换螺杆 (图 16)

- 松开固定螺栓 (1)，并移除旧的螺杆 (6)。
- 用新的固定螺栓安装螺杆。
- 在固定螺栓上涂抹乐泰胶 243。



注意：只可以使用乐泰胶 243。

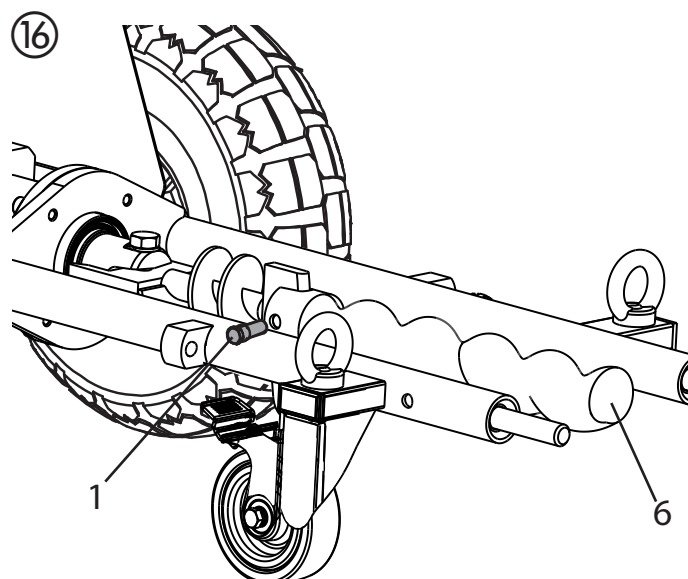

10 常见故障排除

常见故障	可能的原因	故障排除
通电后，绿色电源指示灯显示为绿色，但是电机不转，设备不运行。	转速调节器位于位置“0” 未连接压缩空气软管或缺乏充足的压缩空气供给 空气滤清器脏污（如已安装）	增加输送量 检查压缩空气软管和压缩空气供给 清洁空气滤清器
通电后，绿色电源指示灯不亮，电机不转，设备不运行。	没通电	- 检查电源插座是否损坏 - 检查插线板是否正常 - 检查供电电源是否正常
通电后，红色指示灯亮起（根据闪烁的次数判断故障的类别），电机不转，设备不运行。	连续闪3下：过流 连续闪4下：过压 连续闪5下：欠压 连续闪6下：通讯未建立 连续闪7下：过热 连续闪8下：堵转 持续闪烁不间断：通讯未建立	- 检查螺杆和胶套，齿轮箱，输送杆师傅是否卡死？ - 检查供电电源电压是否正常？ - 检查供电电源电压是否正常？ - 检查急停按钮是否复位？在复位急停按钮3次后，通讯依旧未建立，请联系瓦格纳尔当地指定代理商或瓦格纳尔技术服务热线。 - 检查电机风扇是否故障？如果风扇正常，停机并等待控制器温度降至保护温度范围内，再尝试重启设备。 - 尝试通电3次后，设备仍旧堵转，请联系瓦格纳尔当地指定代理商或瓦格纳尔技术服务热线。 - 请联系瓦格纳尔当地指定代理商或瓦格纳尔技术服务热线。
通电后，绿灯正常，	螺杆在胶套中被咬死。 没有用泵润滑剂对泵进行润滑。	快速将选择开关在位置“F”（向前）-“R”（向后）之间切换。 如果问题无法解决，请联系 Wagner 的客户服务部。
绿灯正常，压力表显示有压力，但是喷枪不出料。	材料在料管中“堵死”。 没有用纤维素胶对料管进行预润滑。	卸除料管的压力 - 将转向开关切换到位置“R”（向后）。 将材料泵回到料斗中。 <div style="border: 1px solid black; padding: 5px; display: inline-block;">  <p>料管必须不带有任何压力。 注意压力表 —> 0 bar。 戴护目镜。</p> </div> 脱开料管，并用水软管彻底冲洗。当堵塞故障排除后，则在料管中灌入纤维素胶。连接料管。

常见故障	可能的原因	故障排除
喷涂过程中，突然不再出料	<p>由于涂料内杂质或涂料颗粒过大，喷嘴堵塞。</p> <p>喷嘴过小。</p> <p>材料在料管中“堵死”。 没有用纤维素胶对料管进行预润滑。</p> <p>泵吸入了空气。</p>	<p>将多功能螺杆泵关闭。 将喷枪上的出料阀关上。 取下喷嘴，并对其进行清洁。</p> <p>使用较大的纹理喷嘴。 经验之谈：颗粒大小 x 3 → 喷嘴大小</p> <p>卸除料管的压力 - 将转向开关切换到位置“R”（向后）。 将材料泵回到料斗中。</p> <div style="border: 1px solid black; padding: 5px; display: flex; align-items: center;">  <p>料管必须不带有任何压力。 注意压力表 → 0 bar。 戴护目镜。</p> </div> <p>脱开料管，并用水软管彻底冲洗。当堵塞故障排除后，则在料管中灌入纤维素胶。连接料管。</p> <p>在料斗中注入材料，并进行循环泵送，直至流出的不含气泡的材料。 注意：要始终注入足量的材料。不得空运行泵。泵运行过热，这会造成“堵死”的危险。</p>
喷涂效果不均匀、雾化效果不佳	<p>纹理喷嘴中的空气通道有一部分被材料堵住。</p> <p>错误设置了空气量。</p> <p>砂浆喷涂机清洁不充分</p> <p>泵吸入了空气。</p>	<p>将砂浆喷涂机关闭。 将喷枪上的出料阀关上。 将纹理喷嘴移除。对纹理喷嘴的空气通道进行清洁。 重新设置空气量。</p> <p>对砂浆喷涂机进行彻底清洁</p> <p>在料斗中注入材料，并进行循环泵送，直至流出的不含气泡的材料。 注意：要始终注入足量的材料。不得空运行泵。泵运行过热，这会造成“堵死”的危险。</p>
压力表上的压力超过40 bar。	<p>材料的粘度过高。</p> <p>料管的直径过小。</p> <p>料管太长。</p> <p>材料在料管中“堵死”。 没有用纤维素胶对料管进行预润滑。</p>	<p>稀释材料。</p> <p>使用直径较大的料管。</p> <p>使用较短的料管。</p> <p>卸除料管的压力 - 将转向开关切换到位置“R”（向后）。 将材料泵回到料斗中。</p> <div style="border: 1px solid black; padding: 5px; display: flex; align-items: center;">  <p>料管必须不带有任何压力。 注意压力表 → 0 bar。 戴护目镜。</p> </div> <p>脱开料管，并用水软管彻底冲洗。当堵塞故障排除后，则在料管中灌入纤维素胶。连接料管。</p>
输送的材料不足	<p>选择了过小的输送量。</p> <p>料管直径过小。</p> <p>胶套发生了磨损。</p> <p>过小的纹理喷嘴。</p>	<p>调高转速。</p> <p>使用直径较大的料管。</p> <p>安装新胶套，需要时还要安装新螺杆。 注意：用泵润滑剂喷涂。</p> <p>选择较大的纹理喷嘴</p>



11 PC 1025PRO 备件清单

项号.	订购编号	名称
1	3142039	环形螺栓
2	2416820	料管密封垫片
3	2439516	出口单元套件
4	348315	胶套
5	2416627	螺杆和胶套 (包括序号4,10,11)
6	2416813	胶套止动器
7	9900247	六角螺栓
8	9921507	垫片
9	2436478	料斗
10	348316	螺杆
11	2416814	螺栓
12	2416628	输送轴
13	2416632	电机密封垫片
14	9921501	垫片
15	9900313	螺栓
16	2416629	电机
17	2416634	气动开关组件
18	2416408	铭牌

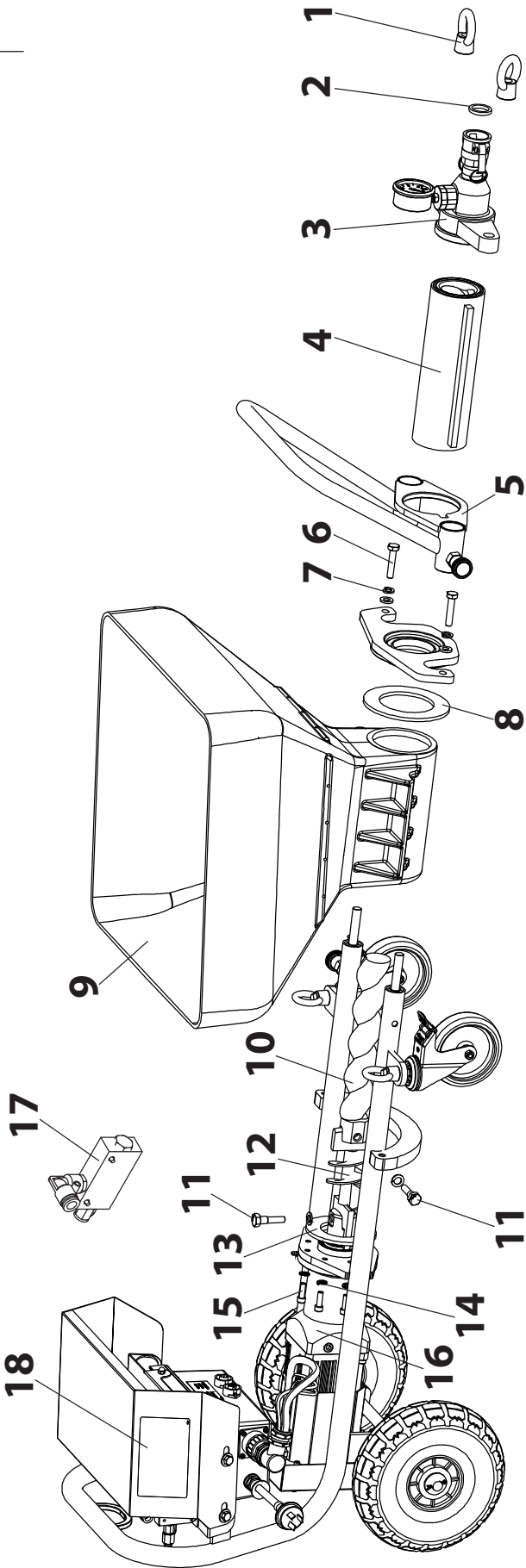

11.1 机架备件清单

项号	订购编号	名称
1	2416991	车架
2	3142039	环形螺栓 M12
3	2416816	换向轮
4	2416631	车轮

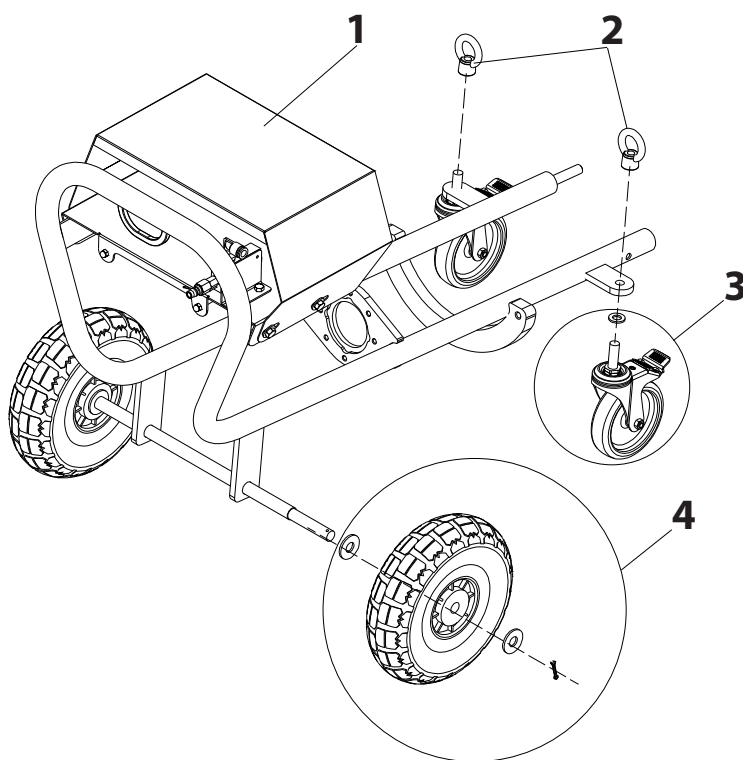

12 喷枪的备件清单

项号	订购编号	名称
	2438 213	喷枪
1	2416 818	锁紧螺母
2	2416 819	密封垫片
3	2416 609	纹理喷嘴 6 (标配)

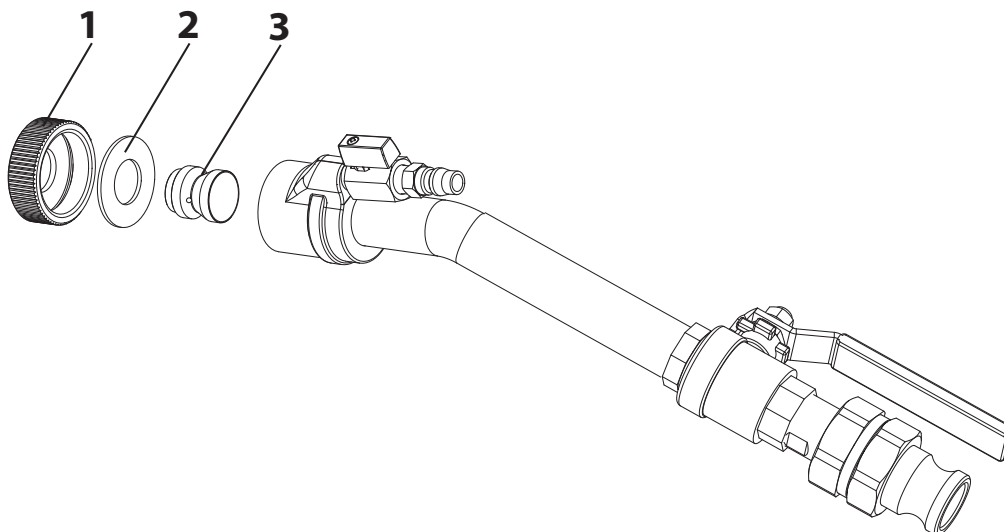

13 PC 1025PRO 配件

项号	订购编号	名称
1	2438 213	喷枪 (含喷嘴6#)
2	2418 450	纹理喷嘴4#
	2416 609	纹理喷嘴6# (喷枪标配)
	2416 610	纹理喷嘴8#
	2416 611	纹理喷嘴10#
	2416 612	纹理喷嘴12#
3	2416 809	料管 DN 19 -6 m (标配)
	2396 956	料管 DN 25 - 10 m
4	2416 820	密封垫片
5	0342 916	清洁通针
6	0342 330	清洁球, 用于 DN 19
	0342 331	清洁球, 用于 DN 27
7	9992 824	泵润滑剂 500 ml
8	0342 241	料管接头 M 27 - GK
	0348 948	料管接头 M 35 - GK
9	2312 136	料管润滑剂 (Metylan 墙纸胶) 125g (无图片)
10	2417 014	油水分离器
11	348316	螺杆 (10 升)
	348926	螺杆 (15 升)
	2385520	螺杆 (20 升)
12	348315	胶套 (10 升)
	348925	胶套 (15 升)
	2385532	胶套 (20 升)
13	2416627	螺杆和胶套 (10 升)

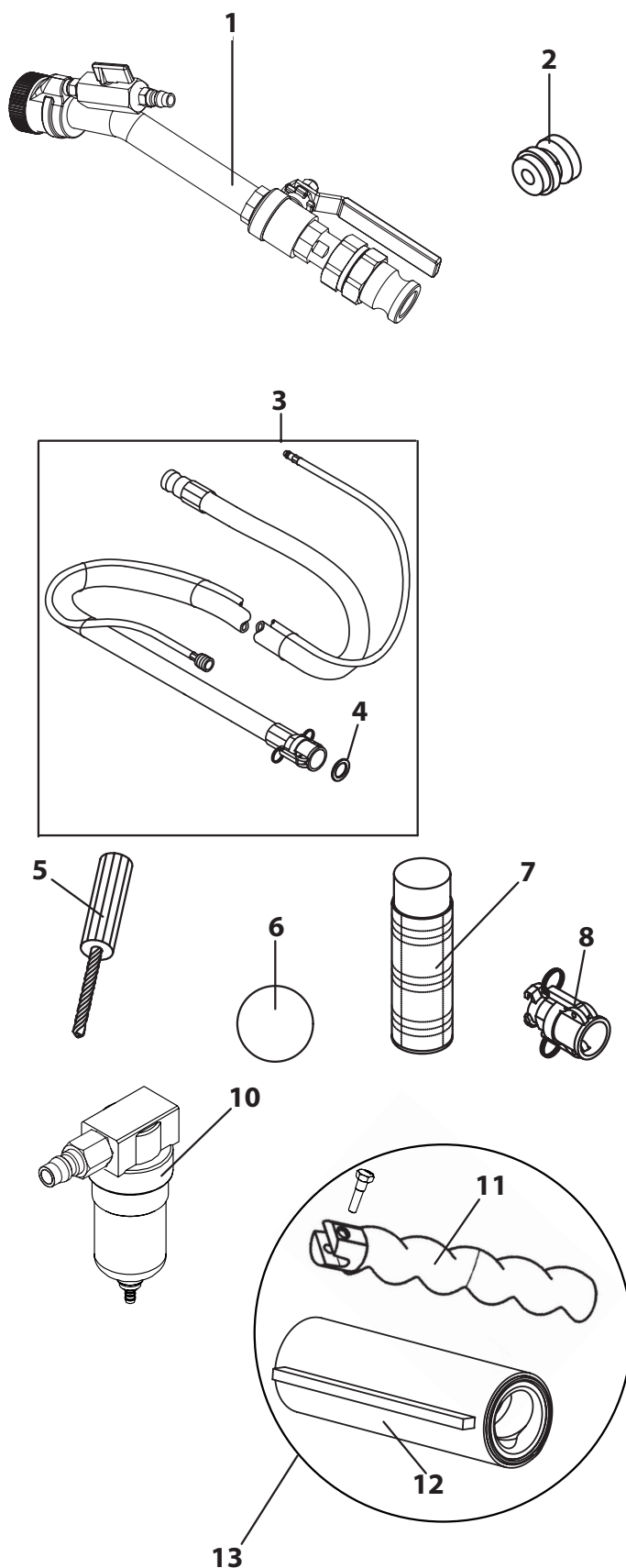

设备试验

为了安全，建议至少每12个月，按照规定，由专业人员对设备进行检查，确保设备能继续安全运行。
如设备没有使用，可推迟检查周期。
同时必须遵循所有（可能有所差异）国家检验和维护法规的规定。
如有问题，请联系瓦格纳尔的客户团队。

产品责任方面的重要信息

1990年1月1日起生效的欧盟指令规定，只有在所有零部件均由制造商制造或批准，且设备正确安装和操作的条件下，制造商方对其产品承担质量责任。
如采用第三方可选件或备件，制造商将免责或仅部分承担责任。在极端情况下，主管部门可能禁止全套设备的使用（德国工业雇主责任保险协会和工厂检查员）。
只有使用瓦格纳尔原装配件和备件方可确保安全运转。

处置说明

遵循废弃电气和电子设备方面的2012/19/EU号欧盟指令和按照国家法律的规定实施时，本产品不得随生活垃圾一起处置，必须以环保方式进行回收利用！



瓦格纳尔建筑涂装标准质保条款

(自2022年02月01日起生效)

该质保承诺仅适用于2022年02月01日以后在瓦格纳尔以及瓦格纳尔授权经销商处购买的所有建筑涂装设备。

标准质保条款

1. 质保范围

所有瓦格纳尔建筑涂装设备（下文简称为“产品”）均严格按照瓦格纳尔质保要求检验、测试和验收。我们只对瓦格纳尔以及我们授权经销商处购买产品的客户提供质保服务。

本质保不影响买方根据购买合同向卖方就产品缺陷索赔或要求法定权利。

瓦格纳尔决定是否更换或维修产品或部件，已更换的产品或部件为本公司所有。

2. 质保期限

标准质保期限为12个月，包括如下产品系列：

HVLP/XVLP系列、隔膜泵SF系列、螺杆泵PlastCoat系列、气动泵PowrCoat系列、液压柱塞泵HC系列、柱塞泵PS系列。

注意：对于工业应用或同等程度损耗的应用，例如：连班工作制或租赁等，质保期减半。

关于质保期限的定义：自瓦格纳尔或我们授权的经销商交付到客户之日起开始计算（请参考购买凭证原件上的日期）。

任何客户在提出质保要求时，必须提供购买凭证原件，包括：发票、收据、转账凭证、支付凭证等具有权威性的凭证。

质保期限仅限设备购买人持有，不可转让。设备质保期限内更换的备品备件，其质保期限依旧按照从设备购买之日算起。超过设备质保期限后，在瓦格纳尔*或我们授权的经销商处更换的备品备件的质保期限为其更换之日算起的90天。

3. 质保流程

若在质保期限内发现设备性能有缺陷，则购买方应立即提出质保索赔。

注：购买方在接收到设备后，请立即对设备进行全面地检查，并在接收到设备之日起的14天内，联系（1）瓦格纳尔授权的经销商，或者（2）瓦格纳尔，并提交其质保索赔，同时提供相关的信息，从而有效地保障您的质保权利。

技术支持与服务中心地址：

J. Wagner GmbH
Otto-Lilienthal-Straße 18
D-88677 Markdorf
Germany

Technical Support and Service Hotline:
+49 / 75 44 / 505-1520
email: Technical.Support-DF@wagner-group.com

Customer Service Hotline:
+49 / 75 44 / 505-1666
email: kundenzentrum@wagner-group.com

注：客户须自付运费将产品送修，并附上标有产品采购日期、名称和序列号的有效原始购买凭据。

注：客户送维修中心或返还客户所产生的运费以及产品丢失或受损风险均须由客户承担。

4. 质保免责

以下情形，我们将不予质保：

- 正常使用或自然磨损所造成的老化以及由此导致故障的产品：尤其是电线、阀门、喷嘴、缸套、柱塞杆、涂料流经组件、过滤器、料管、密封圈、螺杆、胶套、包装等部件。尤其是带小颗粒的涂料所造成的磨损，例如：分散剂、石膏、腻子、黏结剂、釉料、含石英涂料。
- 汽油机驱动设备或划线机的离合器组件。
- 由于下述原因导致故障的产品：不遵守操作手册、不适当或不专业的使用、错误组装以及买方或第三方让他人擅自组装、超出产品设计目的的使用、反常的天气、不适宜的涂料、不适宜的工作环境、不正确的电源电压/频率、过度操作、不当的维修/保养/清洁。
- 因使用非瓦格纳尔原装部件而导致故障的产品。
- 擅自改动的产品。

- 序列号被移除或模糊不清的产品。
- 非瓦格纳尔授权人员维修的产品。
- 和设定性能略有偏差，但不影响设备的价值和使用的产品。
- 被部分或全部拆开的产品。

5. 其他

如检查发现了非质保产品，由买方承担修理费用。

上述规定用于调整了我公司与瓦格纳尔保修程序相关的法律关系。

任何额外的索赔，尤其是由于用户对我们产品的不当使用而造成的任何形式的损坏和损失，除非法律和法规另有规定，否则将被排除在产品责任之外。此外，任何非因产品或产品使用直接造成的任何形式的损失的索赔，除非法律合同语言是英文。如本质保的英文文本和其他语言文本意思有偏差时，以英文文本为准。瓦格纳尔建筑涂装保留最终解释权。

J. Wagner GmbH,
Otto-Lilienthal Straße 18,
88677 Markdorf
Germany

Warning!

Mortar spraying machines develop high spraying pressures.

	Attention – Danger of injury!
①	<p>Do not reach into the rotor when it is moving. Risk of crushing. Do not insert objects or body parts through the protective grid.</p> <p>Never reach into the spray jet with your fingers or hand!</p> <p>Never point the spray lance at yourself or other persons!</p> <p>Coating materials are caustic or irritating!</p> <p>Protect your skin and eyes!</p>
②	<p>The following points are to be observed in accordance with the operating manual before every start-up:</p> <ol style="list-style-type: none"> 1. Observe the permissible pressures. 2. Check all the connecting parts for leaks.
③	<p>Instructions for regular cleaning and maintenance of the machine are to be observed strictly.</p> <p>Observe the following point before any work on the machine and at every working break:</p> <ol style="list-style-type: none"> 1. Observe the curing time of the coating material. 2. Depressurize the spray lance and mortar hose. 3. Switch off the suction pump.

Ensure safety!

Table of Contents

1	SAFETY REGULATIONS	28	9	MAINTENANCE	40
2	INTRODUCTION TO WORKING WITH THE MORTAR SPRAYING MACHINE PC 1025PRO	29	9.1	Mechanical maintenance	40
2.1	Function of the mortar spraying machine PC 1025Pro	29	9.2	Electrical maintenance	40
2.2	Processible coating materials	30	9.3	Long periods of non-usage	40
3	TECHNICAL DATA	30	9.4	Shaft seal (fig. 14)	40
4	EXPLANATORY DIAGRAM FOR PC 1025PRO	31	9.5	Seals	41
4.1	Operating elements and displays on device	32	9.6	Rotor replacement (fig. 16)	41
4.2	Drive	32	10	ELIMINATING FAULTS	42
4.3	Compressor (accessory)	33	11	SPARE PARTS LIST FOR PC 1025PRO	45
4.4	Mortar hose	33	11.1	Spare parts list frame	46
4.5	Spray lance	33	12	SPARE PARTS LIST OF SPRAY LANCE	46
5	TRANSPORTATION	34	13	PC 1025PRO ACCESSORIES	47
5.1	Moving	34		Testing of the mortar spraying machine	48
5.2	Transport using a crane (fig. 4)	34		Important information on product liability	48
5.3	Transportation in vehicle	34		Note on disposal	48
6	COMMISSIONING	34		Wagner Standard Guarantee	48
6.1	Installation location	34		Service network	52
6.1.1	Connection to mains power supply/ Extension cable	34			
6.2	Initial starting-up	34			
6.2.1	Scope of supply	34			
6.2.2	Assembly (fig. 5)	35			
6.3	Connecting the mortar hose	35			
6.4	Compressor (accessory)	35			
6.5	Connecting the spray lance (fig. 8)	36			
6.6	Preparing the mortar spraying machine (fig. 9)	36			
6.7	Beginning of the spraying process	37			
6.8	End of the spraying process	37			
7	GENERAL INFORMATION ABOUT THE APPLICATION TECHNIQUE	37			
7.1	Spraying technique	37			
8	SHUTTING DOWN AND CLEANING	38			
8.1	Cleaning the mortar hose	38			
8.2	Cleaning the device and replacing the stator	38			
8.3	Cleaning the spray lance	39			
8.4	Air filter (accessory)	39			

1 SAFETY REGULATIONS

The following sources are just a sample of those containing safety requirements for mortar conveyors:

- a) EN 12001, Conveying, spraying and placing machines for concrete and mortar - Safety requirements

All local safety regulations in force must be observed.

The following specifications are to be observed in particular to handle mortar spraying machines safely:

Usage of the mortar spraying machine

The mortar spraying machine PC 1025Pro may only be used to process the coating materials described on page 30. Any other usage is not allowed.

Proper usage also includes the observance of the operating manual and the observance of the inspection and maintenance conditions. Always keep the operating manual on hand at the point of use of the mortar spraying machine.

The mortar spraying machine PC 1025Pro may only be operated with a manometer. Only the mortar hose specified by the manufacturer may be used.

Use only marked mortar hoses with at least 40 bars operating pressure.

The mortar spraying machine is intended exclusively for commercial use by professionals.

Protection of persons

In order to protect eyes, skin and the respiratory organs: Wear safety goggles, protective clothing, gloves, possibly use protective skin cream and respiratory equipment. Do not decouple the mortar hose as long as it is under pressure. Watch the manometer! Wear safety goggles! Do not point the spray lance at persons!

In order to protect your ears wear ear protection.

Wear safety shoes when transporting the machine or working with it.

People not needed to assist with machine installation, assembly or operation, must keep away from the machine.





The PC 1025Pro is equipped with an EMERGENCY STOP switch for emergencies.

Breathing masks

Make a breathing mask available to the processor in order to protect against mineral dust.

Connection to the mains network only via a special feeding point, for example via a distribution board for construction sites, with residual current protective device with $INF \leq 30 \text{ mA}$.

Avoid soiling of the socket for the remote control at the control unit.

	Risk of injury from escaping material. Before switching on, always check that the material tap on the spray lance is closed. Close material tap whenever stopping work.
	Do not reach into the rotor when it is moving. Risk of crushing. Do not insert objects or body parts through the protective grid.
	Never operate the mortar spraying machine if the rotor is exposed or if the container has been removed. Caution if you have long hair. Only wear close-fitting clothes at work.
	Risk of crushing when folding in the handles, assembling the pump unit and connecting the mortar hose.

Cleaning and maintenance

Never decouple mortar hose or disassemble machine when under pressure. Note pressure reading on pressure gauge.

When performing maintenance work, always switch off mortar spraying machine, disconnect mains plug and ensure it cannot be plugged back in by mistake.

Do not spray down the motor and control unit of the mortar spraying machine with a water-jet, high-pressure cleaner or high-pressure steam cleaner. Danger of short-circuits caused by water ingressing.

Electrical equipment

Work on the machine's electrical equipment may be carried out only by a qualified electrician. The electrical equipment is to be checked regularly. Eliminate faults such as loose connections or scorched cables.

Keep the label on the mortar spraying machine clean and legible.

	Whenever the machine is automatically brought to a standstill or during power failure, immediately move the selector switch to "A" to prevent the machine starting back up again unintentionally. There is a danger of injury.
---	---

Mortar hose

	Danger of injury through leaking high-pressure hose. Wear and tear and links as well as usage that is not appropriate to the purpose of the device can cause leakages to form in the mortar hose. Liquid can be injected into the skin through a leakage.
---	--

Mortar hoses must be checked thoroughly before they are used.

Replace any damaged mortar hose immediately.

Never repair defective mortar hoses yourself!



Avoid sharp bends and folds: the smallest bending radius is about 80 cm.

Do not drive over the mortar hose. Protect against sharp objects and edges.

Never pull on the mortar hose to move the device.

Do not twist the mortar hose.

Lay the mortar hose in such a way as to ensure that it cannot be tripped over.

	Only use WAGNER original-mortar hoses in order to ensure functionality, safety and durability.
	The risk of damage rises with the age of the mortar hose. Wagner recommends replacing mortar hoses after 6 years.

Setup on an uneven surface

The mortar spraying machine must be installed as shown in the diagram below to prevent it slipping. Block front wheels with brakes.

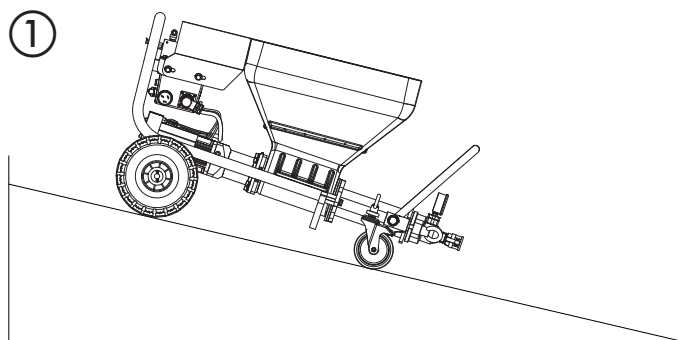

2 INTRODUCTION TO WORKING WITH THE MORTAR SPRAYING MACHINE PC 1025PRO

The suction pump PC 1025Pro is conceived for using and processing ready mixed mineral coating materials.

PC 1025Pro offers a wide range of applications, including residential building, commercial building, new rural construction, fire proofing projects, anti-corrosion projects, water proofing projects, grouting projects, reinforcement project etc.

The machine is not designed for use as a cleaning device.

2.1 FUNCTION OF THE MORTAR SPRAYING MACHINE PC 1025PRO

The coating material is supplied by means of the container. The spiral conveyor feeds the coating material to the eccentric screw pump. The suction effect causes the coating material to enter the eccentric screw pump. This pump builds up the pressure required for transportation through the mortar hose. The compressed air required for atomisation is supplied at the spray lance. The mortar spraying machine can be switched on and off using the electric control. This can also be used to control the delivery volume.

A soft even spray pattern can be achieved by means of the smoothly regulated convey capacity of the coating material.

2.2 PROCESSIBLE COATING MATERIALS

PC 1025Pro can be used with a variety of materials, including below:

- Stone Paint
- Putty (putty with sand, putty with fibers)
- Thermal insulation composite system bonding agent (mineral and artstoneifical resin systems)
- Artificial resin plasters
- Silicate plasters
- Silicone resin plasters
- Mineral final coats
- Lightweight plaster systems
- Scraped stucco
- Thermal insulation plasters
- Restoration plaster
- Porous concrete coating
- Quartz plastic
- Roof coatings
- Fire protection coatings
- Mineral sealing sludges
- Bitumen emulsions
- Armoring filler
- Liquid wood-chip wall paper
- Casement grouting mortar
- Artificial resin rendering base
- Wash primer
- Filling paint, also fibrous
- Elastic coating
- Acoustic plaster, artificial resin bonded
- Fillers, artificial resin bonded

Remark:

- The maximum allowable grain size is 6 mm
- All the coating materials must be suitable for machine processing. Refer to the product data sheet of the coating material to be processed or contact your authorized Wagner dealer or the Wagner hotline at 400-6118-808.

3 TECHNICAL DATA

	PC 1025Pro
Voltage:	230 V~, 50/60 Hz
Fusing:	16 A time-lag
Device supply cable:	5 m long, 3 x 2.5 mm ²
Motor output P _i :	2.3 kW
Max. convey capacity (water):	10, 15, 20 l/min (depending on the rotor/ stator)
Max. operating pressure:	40 bar
Max. granular size:	6 mm
Dimensions L x W x H:	1150 x 520 x 610 mm
Container capacity:	50 l
Weight (PC 1025Pro):	59 kg
Weight (Spray lance):	1.0 kg
Max. tyre pressure:	2.0 bar
Degree of protection:	IP 54
Max. sound pressure level:	70 dB (A)*
Atomizing air connection:	Rapid action coupling DN 7.2 mm
Max. atomizing air pressure:	10 bar
Minimum required compressed air volume:	320 l/min
Max. mortar hose length:	40 m (and 2.5 m hose whip)
Max. delivery height:	20 m

* Place of measurement: 1 m distance from unit and 1.60 m above reverberant floor.

4 EXPLANATORY DIAGRAM FOR PC 1025PRO

- | | |
|---|--|
| 1 Connection for the spraying lance's air hose | 2 Connection for compressed air supply (compressor) |
| 3 Control unit | 4 Control panel with selector switch for operating mode and delivery volume controller |
| 5 Indicator light red (indicates the presence of a malfunction) | 6 Operating light green (indicates that mains voltage is present) |
| 7 EMERGENCY STOP switch | 8 Container |
| 9 Pressure gauge | 10 Outlet unit with inside screw pump |
| 11 Connecting coupling for mortar hose | 12 Mortar hose with air hose complete |
| 13 Spray lance | 14 Flow switch connection |
| 15 Air filter (accessory) | |

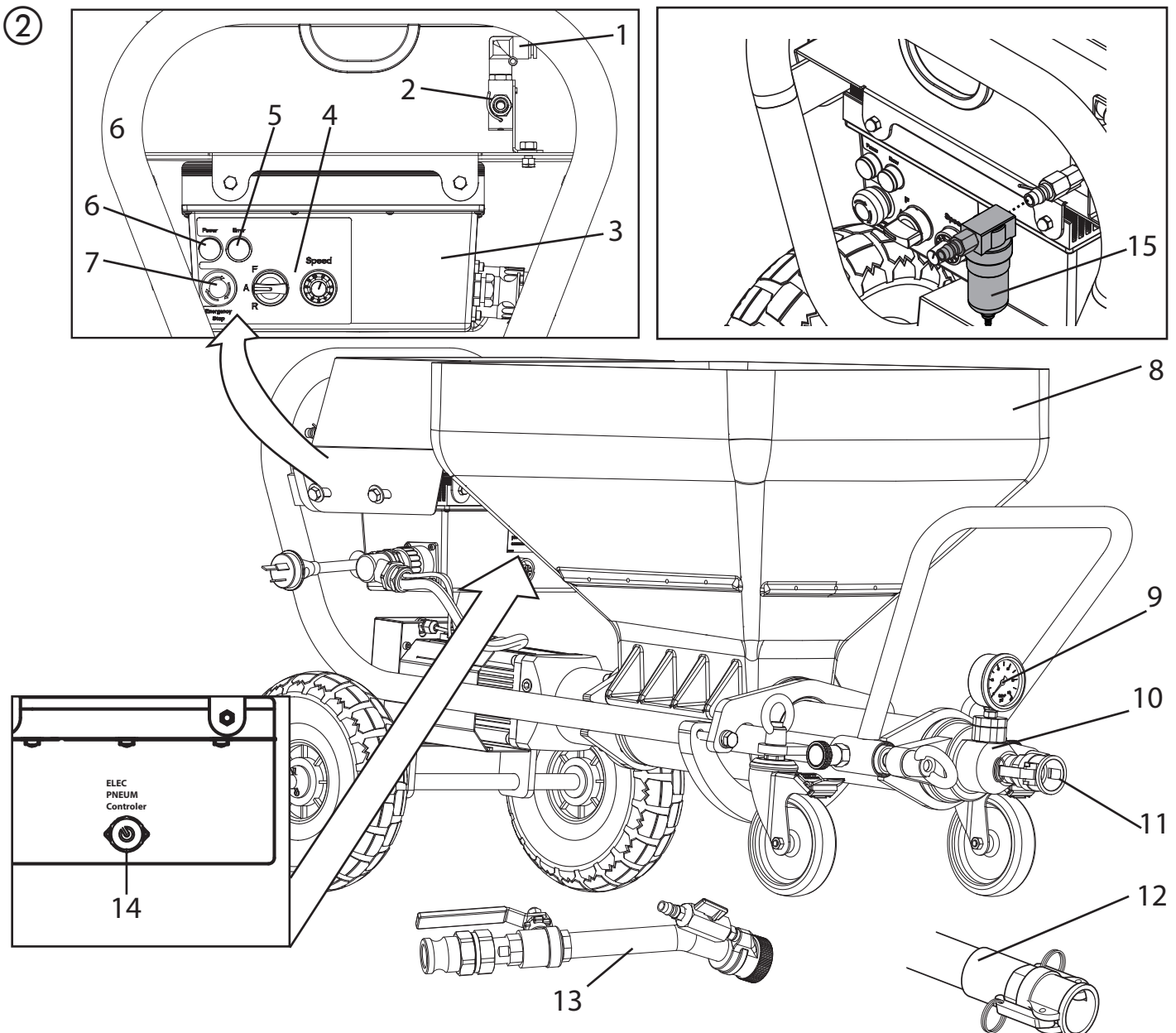

4.1 OPERATING ELEMENTS AND DISPLAYS ON DEVICE

- 1 Delivery volume controller 0-10
- 2 Selector switch for operating mode
- 3 Indicator light (Error)
- 4 Operating light (Power)
- 5 EMERGENCY STOP switch

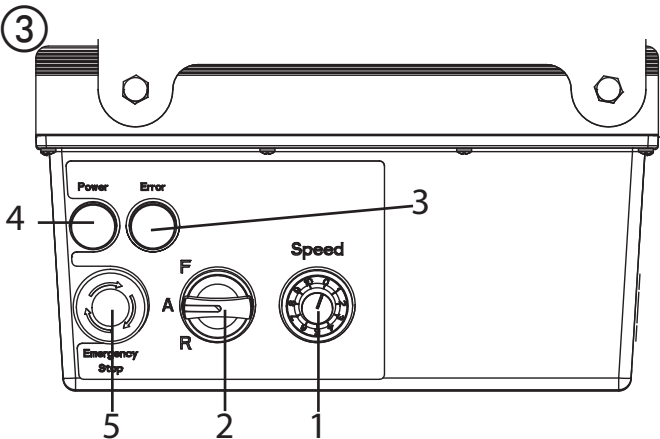

The delivery volume controller (Fig. 3, 1) is used to regulate the convey capacity from 0-10 smoothly.

The selector switch (Fig. 3, 2) offers the following modes:

	"A" position = automatic Basic setting for control with a pneumatic spray lance
	"F" position = manual activation Switches on the mortar spraying machine. This setting is required for: <ul style="list-style-type: none">• disassemble stator• pre-rinsing the mortar hose to improve the material's ability to slide• cleaning
	"R" position = reverse gear This setting is required for: <ul style="list-style-type: none">• assemble stator• pressure relief manually

Detailed explanation of selector switch use:

If the selector switch is in the "A" position, the PC 1025Pro can be switched on and off with the air flow regulator on the spray lance.
If there is no spray lance fitted (e.g.: assembly/disassembly the pump unit), the machine is switched on using the "F" switch position and off using the "A" position.



Important: control via the selector switch and material shut-off are treated equally.
The machine can be switched from the "A" position (control using material shut-off) to "F" at any time.
We would therefore recommend that only one person operate the machine.

The operating light (green, Fig. 3, 4) indicates that the machine is energised and ready.
When the mains plug is connected the PC 1025Pro carries out a function check. While this is going on the indicator light (red, fig. 3.3) flashes. If everything is in working order, the flashing stops after about 30 seconds. If the indicator light lights up during operation, this indicates that there is a malfunction. For detailed information about this kind of fault, refer to the „Rectification of faults“ section on page 42.



If the selector switch is in the "F" position when the mains plug is plugged in, the machine will not switch on.
Briefly move selector switch to "A" and then back to "F" to switch on the machine.

EMERGENCY STOP switch

When the EMERGENCY STOP switch is pressed, the PC 1025Pro is switched off immediately.
Turn the EMERGENCY STOP switch in order to release it again. The machine remains switched off after release. To switch it on again, the selector switch must be briefly set to "A" and then to "F".

4.2 DRIVE

When an overload occurs, the mortar spraying machine switches off automatically (red indicator light lights up).
Move selector switch (Fig. 3, 2) to "A" and disconnect mains plug. Set delivery volume controller (Fig. 3, 1) to „0“.
Wait around 5 minutes, then plug the mortar spraying machine back in and switch on. Set the delivery volume required.



The drive unit heats up during operation. This is normal and not a sign of malfunction.

4.3 COMPRESSOR (ACCESSORY)

VKM 592 intake volume 590 l/min

Note:

Only operate the compressor in accordance with the enclosed operating manual.

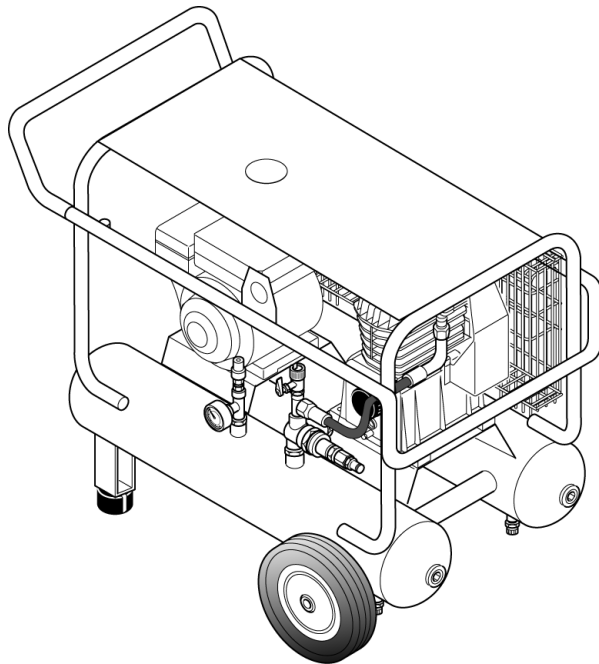

C330 intake volume 330 l/min

Note:

Only operate the compressor in accordance with the enclosed operating manual.

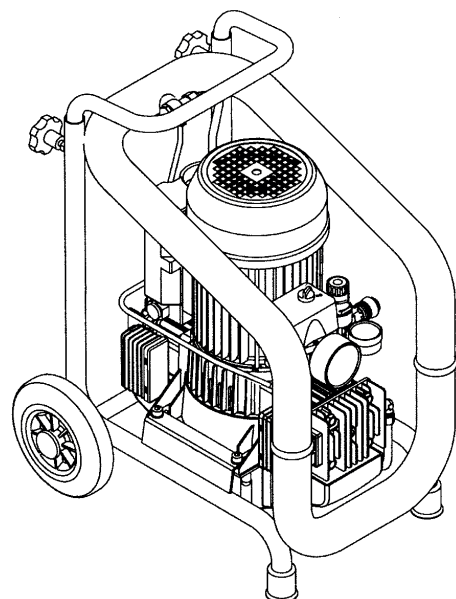

4.4 MORTAR HOSE

- 1 Material connection mortar spraying machine
- 2 Atomizing air connection compressed air supply
- 3 Material connection spray lance
- 4 Mortar hose
- 5 Atomizing air connection spray lance

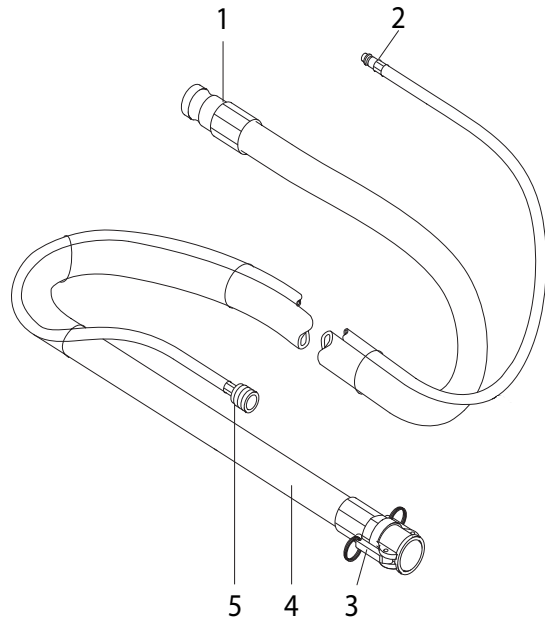

4.5 SPRAY LANCE

- 1 Material connection
- 2 Material tap:
Open: material tap points backwards
Closed: material tap at 90° to spray lance
- 3 Texture tip:
Various texture tips can be used in the spray lance. The tip size depends on the granular size of the coating material and the desired spray pattern.
- 4 Air flow regulator (switches the machine on and off)
- 5 Atomization air connection

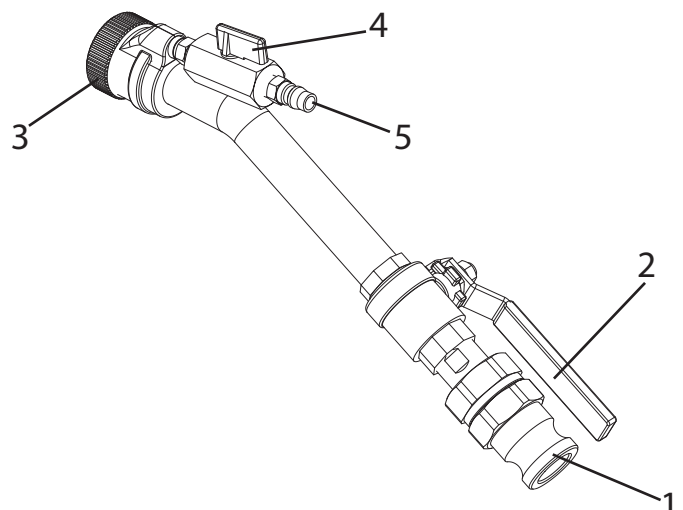

5 TRANSPORTATION

5.1 MOVING

Wind power cable around handle and remove the hose.
Push or pull the PC 1025Pro by the handle.



Make sure that 2 people are available to carry the device on stairs.

5.2 TRANSPORT USING A CRANE (FIG. 4)

For attaching points for the straps or rope (not wire cable) see figure.

④

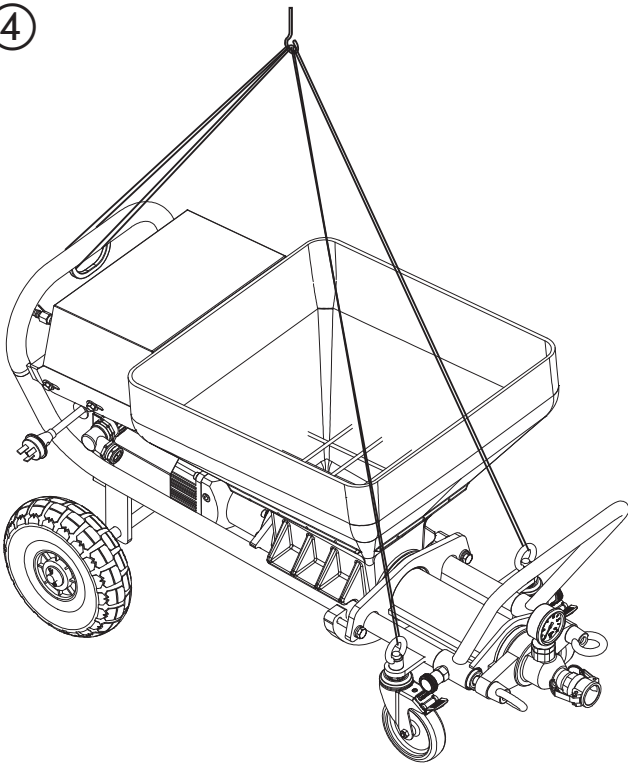

5.3 TRANSPORTATION IN VEHICLE

Secure the unit in the vehicle by means of suitable fasteners.



To avoid material residues leaking from the machine, clean the device in advance or lock the mortar connection.

6 COMMISSIONING

6.1 INSTALLATION LOCATION

Position mortar spraying machine in a level position to prevent it from sliding away.

6.1.1 CONNECTION TO MAINS POWER SUPPLY/ EXTENSION CABLE

Connection to the mains network only via a special feeding point, for example via a distribution board for construction sites, with residual current protective device with $INF \leq 30 \text{ mA}$.



Lay the device supply cable so that there is no danger of stumbling.
Protect against damage, for example against being driven over.



Min. wire cross-section $3 \times 2.5 \text{ mm}^2$. Unroll the extension cable completely. Ensure that the coupling pieces and plugs are free of damage.

- Before connecting the unit to the mains supply, ensure that the line voltage matches that specified on the rating plate.

6.2 INITIAL STARTING-UP

6.2.1 SCOPE OF SUPPLY

The machine is supplied by the manufacturer in the following individual components:

- Complete basic machine comprising drive unit, control unit, receptacle and transport frame with wheels
- Rotor and stator
- Hose package
- Spray lance
- Nozzles, nozzle cleaner and cleaning ball (2 pcs)

6.2.2 ASSEMBLY (FIG. 5)



Disconnect external controls. Assembly may only be carried out by the person who controls the machine. Never operate mortar spraying machine with an exposed rotor. Do not reach into the rotor when it is moving. Risk of crushing. Caution if you have long hair. Only wear close-fitting clothes at work.

Loosen the ring bolts (1) and remove the outlet unit (2).
Spray the stator (3) and rotor (4) with a suitable pump lubricant (order no. 9992 824).

Move selector switch (6) to "A" and set delivery volume controller (7) to „0“.

Connect mains plug to mains power supply.

The operation light (8) shows operational readiness.

The red indicator light (9) flashes during the function check for about 30 seconds.

Set delivery volume controller (7) to 1 or 2.

Push the stator (3) over the tip of the rotor (4) (guide rail (5)).

Set the selector switch (6) to „R“ to push the stator automatically on to the rotor.

As soon as the stator is in end position, set the selector switch (6) to „A“.

Re-assemble the outlet unit (2) and tighten the ring bolts (1).

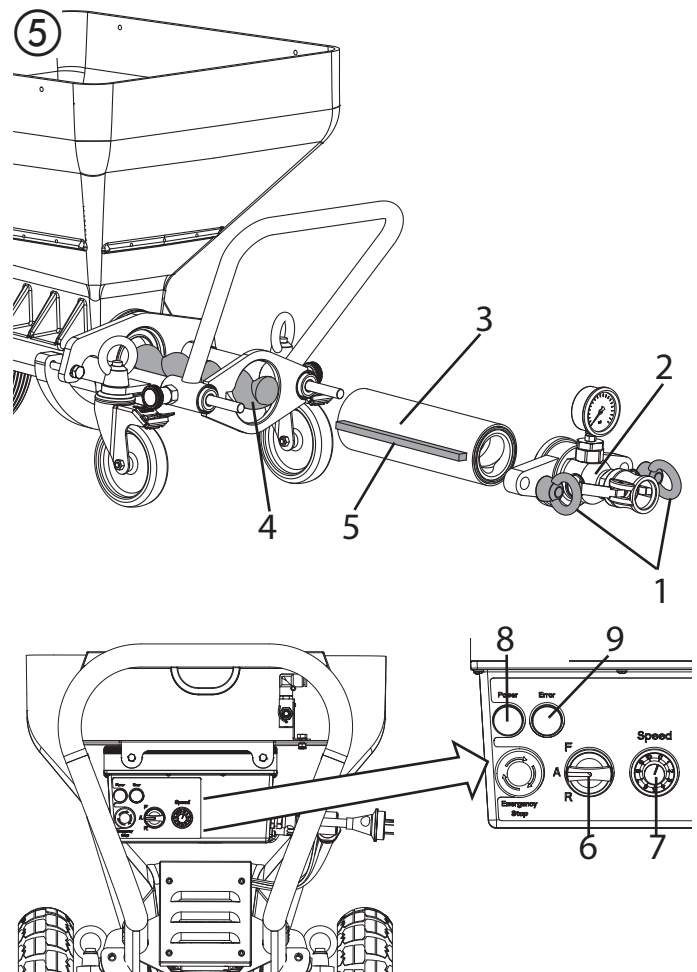

6.3 CONNECTING THE MORTAR HOSE

- Check that the pump unit is seated firmly.
- Check the seal (Fig. 6, 1) in the outlet unit.
- Connect the mortar hose (Fig. 6, 2) and secure it with the clamping levers (3).
- Connect the atomizing air connection on the mortar hose to the front connection of the flow switch (Fig. 7, 1) and the air hose of the compressor (accessory) to the rear connection of the flow switch (Fig. 7, 2).

6.4 COMPRESSOR (ACCESSORY)

Place the compressor at a secure location next to the mortar spraying machine and connect it to the mains network.

Note:

Only operate the compressor in accordance with the enclosed operating manual.

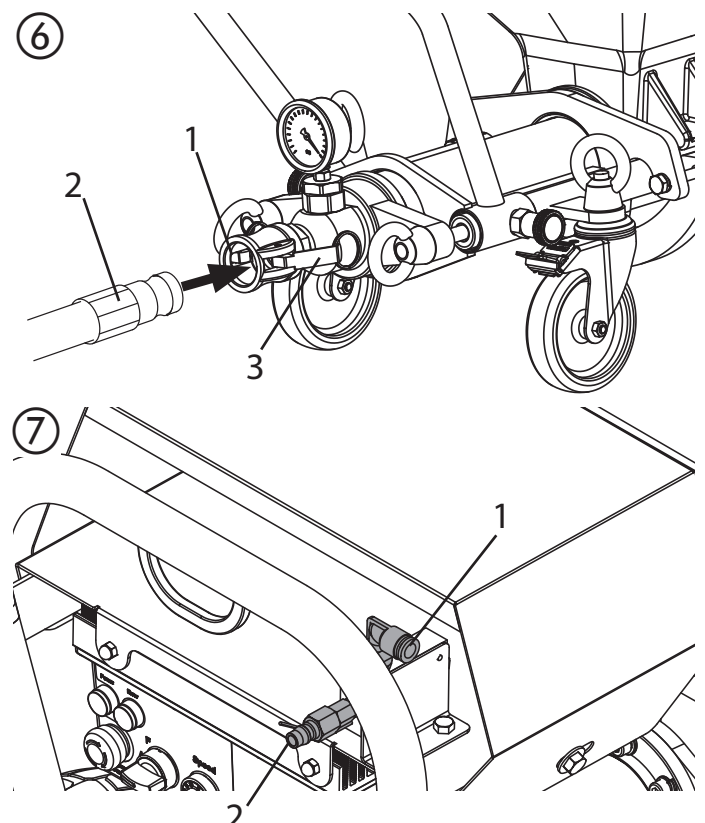

6.5 CONNECTING THE SPRAY LANCE (FIG. 8)

- Select a spray tip suitable for the material:

The tip size should amount to at least three times the granular size, e.g.

granular size artificial resin plasters → 3 mm

Tip size → 10 mm

- Mount the texture tip (1) in the spray lance with the cone pointing towards the spray head.
- Connect the spray lance (2) to the material hose and secure by applying the levers (3).
- Close the material tap (4) (material tap at 90° to spray lance).
- Connect atomization air connection (5) to the air hose of the mortar hose.
- Set selector switch to "A".

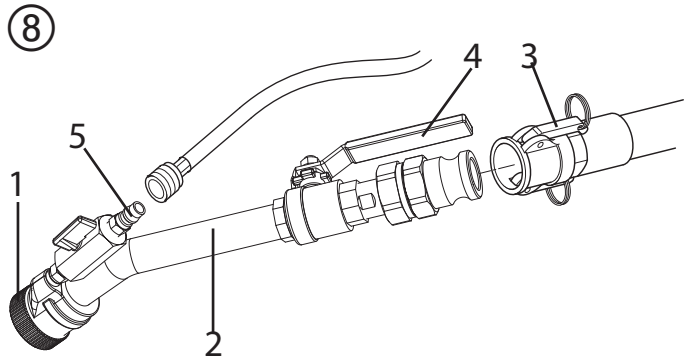

6.6 PREPARING THE MORTAR SPRAYING MACHINE (FIG. 9)

Recommended sliding means for the mortar hose



Water is not sufficient as a sliding means.
Danger of clogging!
Use cellulose paste (e.g. Metylan wallpaper paste, art no. 2312136)

- Fill 2–3 l cellulose paste into the container.
- Connect the mortar spraying machine to the mains supply. The operation light (1) shows operational readiness.



Risk of injury from escaping material.
Before switching on, always check that the air flow regulator and the material tap on the spray lance are closed (material tap at 90° to spray lance).
Close air flow regulator and material tap whenever stopping work.

- Set selector switch (2) to "F".
- Set delivery volume controller (3) to „3“.



Do not bend the mortar hose!
Protect it against damage, for example against being driven over as well as against sharp objects and edges.

- Hold spray lance over an empty bucket.
- Open material tap (Fig. 10, 1) on spray lance (material tap points backwards), the mortar spraying machine is switched on.
- If cellulose paste comes out of the tip, close the material tap (fig. 10, 1) (material tap at 90° to spray lance).
- Fill coating material into the receptacle.



With mineral coating materials only fill the receptacle to half full.

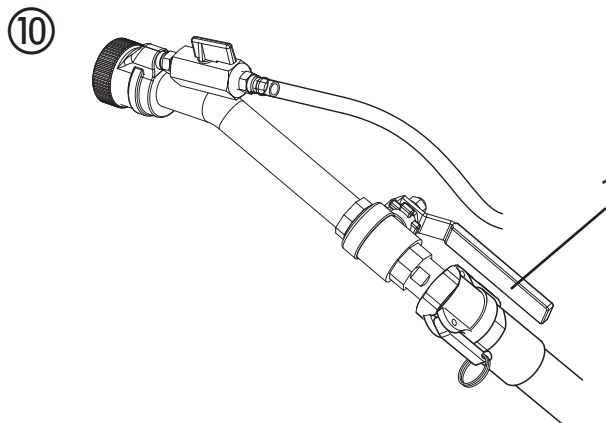
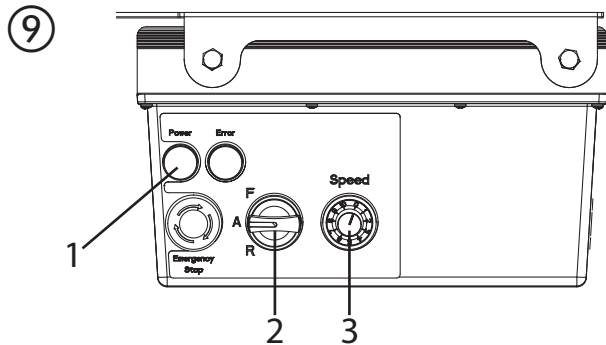

- Position the spray lance over the bucket again.
- Hold spray lance above container with cellulose paste.
- Open material tap (Fig. 10, 1) on spray lance.



- As soon as coating material exits from spray lance, close material tap (Fig. 10, 1).
- Set selector switch (Fig. 9, 2) to "A".
The mortar spraying machine is now full and ready.

6.7 BEGINNING OF THE SPRAYING PROCESS

- Open the air flow regulator (fig. 11, 3) and the material tap (11, 1) at the spray lance.
- Adjust the flow of material with the delivery volume controller (fig. 11, 2) on the control unit and set the air quantity by adjusting the air flow regulator (fig. 11, 3) to attain the desired spray pattern.

	Important: Do not let the mortar spraying machine run dry. Switch the device off immediately if no more material comes out of the tip or if the spray line becomes irregular. Possible reasons for the problem and how to correct it can be found in the chapter called „Eliminating faults“.
	Increased material tap wear. Do not use the material tap to set the material volume. The delivery volume controller should be used for this purpose.

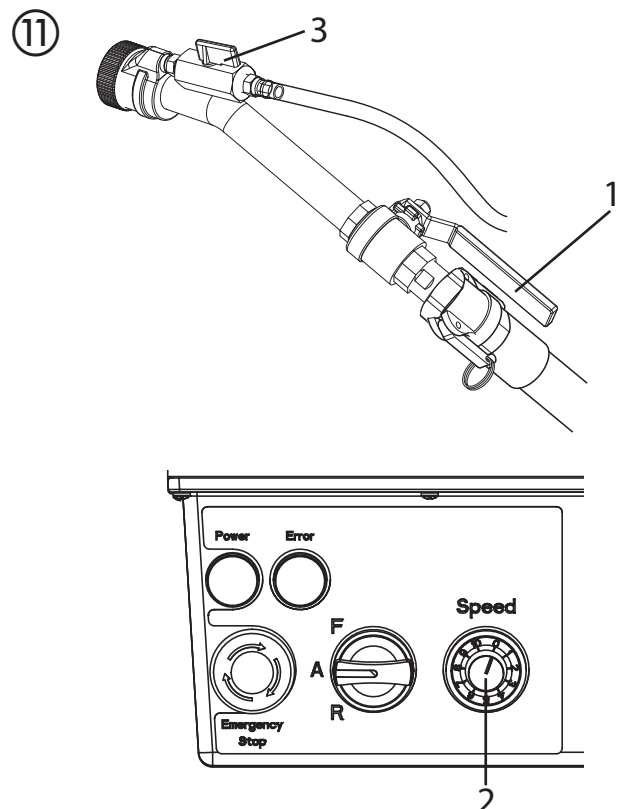

6.8 END OF THE SPRAYING PROCESS

- Close the material tap (Fig. 11, 1).
- Close the air flow regulator (fig. 11, 3).

	Always close material tap at end of the spray process.
---	---

7 GENERAL INFORMATION ABOUT THE APPLICATION TECHNIQUE

7.1 SPRAYING TECHNIQUE

While spraying hold the spray lance at a uniform distance of 30 – 60 cm from the object. Otherwise the spray pattern will be uneven.

The spray pattern depends on the coating material, viscosity, tip size, convey capacity and amount of atomizing air.

Examples:

- Fine texture** → large amount of atomizing air
Rough texture → small amount of atomizing air
Higher convey capacity → larger amount of atomizing air

Test the desired texture on a test surface.

The lateral limit of the spray jet should not be too sharp. The distance between the spray lance and the object should therefore be selected correspondingly.

GENERAL INFORMATION ABOUT THE APPLICATION TECHNIQUE

The spray edge should be gradual in order to facilitate overlapping of the next coat.

If the spray lance is moved parallel and at an angle of 90° to the surface to be coated, the paint mist is minimized.

Note:

Grains and pigments with a sharp edge result in a high rate of wear of the pump, mortar hose, material tap and tip.

	<p>When using the mortar hose while working on scaffolding, it is best to always guide the hose along the outside of the scaffolding.</p>
---	--

8 SHUTTING DOWN AND CLEANING

	<p>Do not clean the motor and control unit of the mortar spraying machine moistly. And certainly do not spray down the unit with high-pressure cleaners or high-pressure steam cleaners. Danger of short-circuits caused by water ingressing.</p>
--	--

8.1 CLEANING THE MORTAR HOSE

- Pump until receptacle is empty.

	<p>Important: Do not let the mortar spraying machine run dry. Switch the device off immediately if no more material comes out of the tip or if the spray line becomes irregular. Possible reasons for the problem and how to correct it can be found in the chapter called „Eliminating faults“.</p>
---	---

- Switch off mortar spraying machine and compressor.
- Close material tap on spray lance.
- Remove the texture tip from the spray lance and clean it.
- Put water in the container and hold the spray lance over an empty bucket.

Important: Do not let the mortar spraying machine run dry. During the cleaning process, ensure that there is always enough water in the container.

- Set delivery volume controller to „5“.
- Open material tap on spray lance.
- Pump material out of hose into container until the material exiting the hose is just a thin liquid.
- Close material tap on spray lance.

	<p>The mortar hose must be pressureless. If necessary, set the selector switch briefly to „R“ (reverse). Watch the manometer --> 0 bar. Wear safety goggles.</p>
--	--

- Decouple mortar hose from pump unit.
- Decouple spray lance from mortar hose.
- Insert cleaning ball into mortar hose and reconnect mortar hose
- Set selector switch to „F“.

- After a few seconds the cleaning ball is emitted from the spray lance.
- Depending on the processed coating material, repeat the cleaning process 3 – 4 times.

	<p>The mortar hose must be pressureless. If necessary, set the selector switch briefly to „R“ (reverse). Watch the manometer --> 0 bar. Wear safety goggles.</p>
---	--

- Set selector switch to „A“.
- Decouple mortar hose from pump unit.

	<p>A further cleaning option is to use the cleaning adapter (accessory). This cleaning adapter can be connected to a water hose or a tap by means of the claw coupling. Insert cleaning ball into the mortar hose. Couple the mortar hose to the cleaning adapter and rinse through with water.</p>
---	---

8.2 CLEANING THE DEVICE AND REPLACING THE STATOR

- Clean mortar spraying machine.
To do so, pump a suitable pump lubricant or water mixed with washing-up liquid through the pump.

Dismantling

	<p>Mortar spraying machine must be depressurised. If necessary, set the selector switch briefly to „R“ (reverse). Watch the manometer --> 0 bar. Wear safety goggles.</p>
---	---

	<p>Disconnect external controls. Disassembly may only be carried out by the person who controls the machine. Never operate mortar spraying machine with an exposed rotor. Do not reach into the rotor when it is moving. Risk of crushing. Caution if you have long hair. Only wear close-fitting clothes at work.</p>
---	---

- Move selector switch (fig. 12, 1) to „A“ and set delivery volume controller (2) to „0“.
- **Disconnect mains plug.**
- Loosen the ring bolts (3) and remove the outlet unit (4).
- Set delivery volume controller (2) to 1 or 2.
- **Connect mains plug to mains power supply.**
- Move the selector switch (1) to position „F“. As soon as the stator (5) is released from the rotor (6), set the selector switch to „A“.
- Remove the stator (5) completely.
- **Disconnect mains plug.**

Clean the outlet unit

Clean the outlet unit (4) with a jet of water and a suitable bottle brush.

Clean the container (7) with a jet of water and a suitable brush.

Clean the protective grid with a radiator brush.

Also clean the rotor (6) and stator (5) thoroughly with water and, if necessary, using a brush.

Then spray rotor (6) and stator (5) and with a suitable pump lubricant.

Keep the thread of the pump housing and the pump tube clean so that leaking after the assembly is avoided.

Mounting



If the machine is down for a longer period of time, the stator can become set at the rotor. Therefore, if the stator has been in storage for a longer period of time, do not mount it until you are about to begin work.

Assembly, see chapter 6.2.2

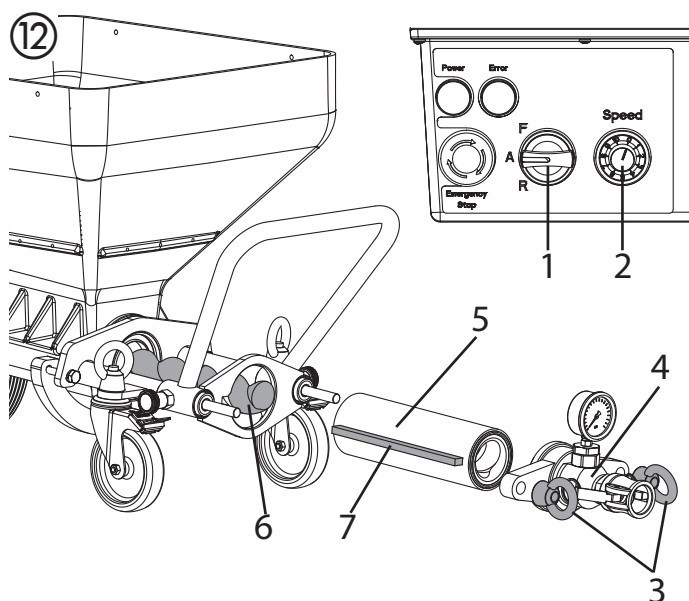

8.3 CLEANING THE SPRAY LANCE

- Clean the texture tip.
- Use cleaning needles to clean the air holes in the texture tip.
- Clean the spray lance and material tube on the inside using a bottle brush (0342 329).
- Clean all threads thoroughly.
- Rinse the spray lance with clear water. Open and close the material tap three times as you are doing this.

8.4 AIR FILTER (ACCESSORY)

- Remove the air hose.
- Unscrew the filter cover (1) from the filter housing (6) (take care to ensure that none of the components 2 - 5 are lost).
- Check the filter (3) and if necessary clean with warm soapy water or replace.
- Turn the filter housing (6) around by 180°.
- Reinsert all of the components and screw the filter cover (1) back into the filter housing.
- Turn the filter housing back to the starting position.

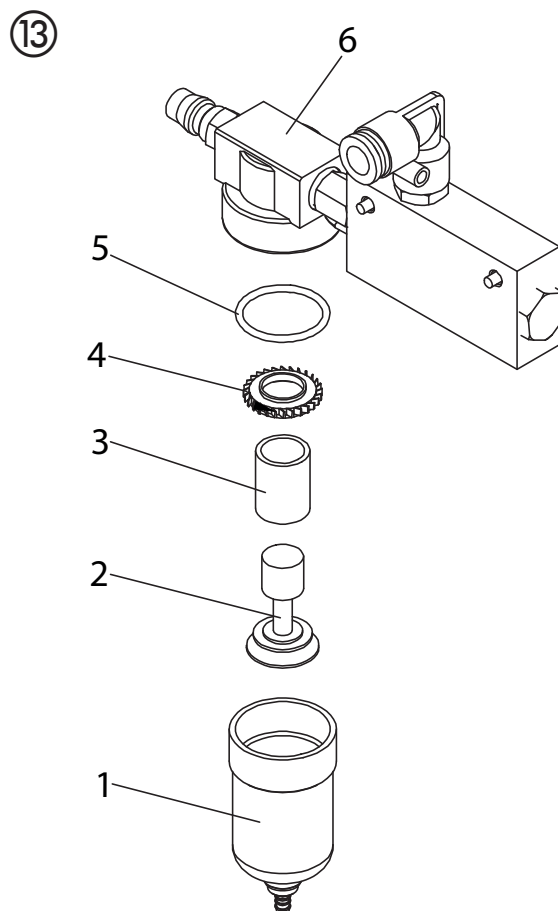

9 MAINTENANCE

	<p>ATTENTION! It is imperative that the machine be deenergized by unplugging the plug before all work and maintenance work. Otherwise there is a danger of short-circuiting! Repairs may only be carried out by qualified personnel who dispose the corresponding training and experience. The device must be tested by a skilled electrician after every repair.</p>
--	--

The mortar spraying machine is designed so that a minimum of care and maintenance is required. However, the following work has to be carried out and components checked regularly:

9.1 MECHANICAL MAINTENANCE

- Keep the thread at the pump tube and pump housing clean and, if appropriate, seal.
- Check the seals at all the couplings and connecting pieces for leaks. If appropriate, replace worn seals.
- Check the following for damage before every usage:
 - Mortar hose
 - Power cable
 - Control unit

9.2 ELECTRICAL MAINTENANCE

- The electrical drive and its ventilation slots must always be kept clean and may not be cleaned with water. **Danger of short-circuits.**

9.3 LONG PERIODS OF NON-USAGE

If the mortar spraying machine is not used for a longer period, it has to be cleaned thoroughly and protected against corrosion.

	<p>Take the stator out of the pump unit so that it cannot get stuck to the rotor.</p>
--	---

9.4 SHAFT SEAL (FIG. 14)

	<p>ATTENTION! A dirty shaft seal can cause serious damage to the drive unit. Check and clean the shaft seal after each use. Replace the shaft seal after 500 operating hours or once a year.</p>
---	---

- Check the shaft seal (1) and clean thoroughly with the enclosed bottle brush.

	<p>Contact Wagner Service if the shaft seal is damaged or cannot be cleaned properly. Damage caused by inadequate cleaning is not covered by the warranty.</p>
---	--

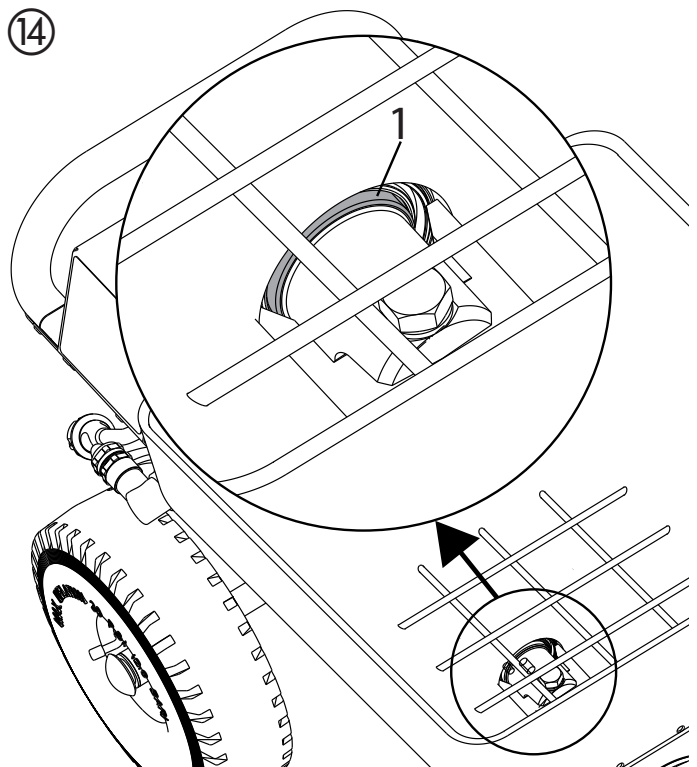

9.5 SEALS



Check the seals on the PC 1025Pro every month.

- Move selector switch (fig. 15, 1) to "A" and set delivery volume controller (2) to „0“.
- **Disconnect mains plug.**
- Loosen the ring bolts (3) and remove the outlet unit (4).
- Set delivery volume controller (2) to 1 or 2.
- **Connect mains plug to mains power supply.**
- Move the selector switch (1) to position „F“. As soon as the stator (5) is released from the rotor (6), set the selector switch to „A“.
- Remove the stator (5) completely.
- **Disconnect mains plug.**
- Pull out the two locking pins (7) and remove the anti-twist lock (8).
- Remove the flange (9) with a 17-wrench.
- Remove the container (10).
- Check the seal (11,12) and replace if necessary.
- Check the rotor (6) and replace if necessary (see chapter 9.6).

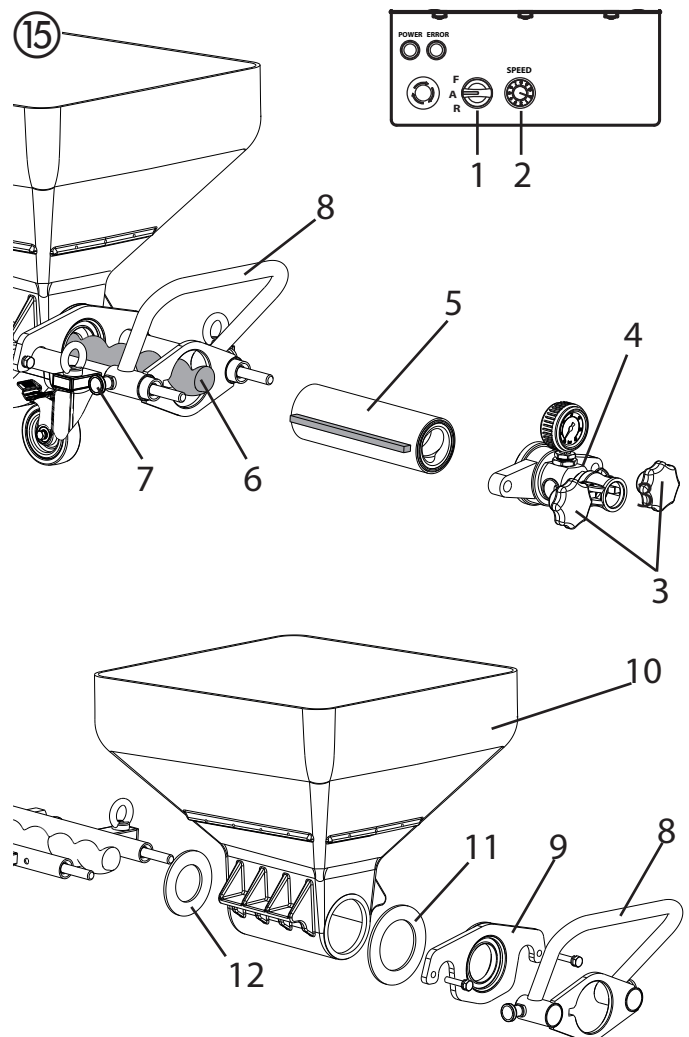

9.6 ROTOR REPLACEMENT (FIG. 16)

- Loosen fixing screw (1) and remove old rotor (6).
- Fit new rotor with new fixing screw.
- Glue fixing screw with Loctite 243.



Note: use Loctite 243 only.

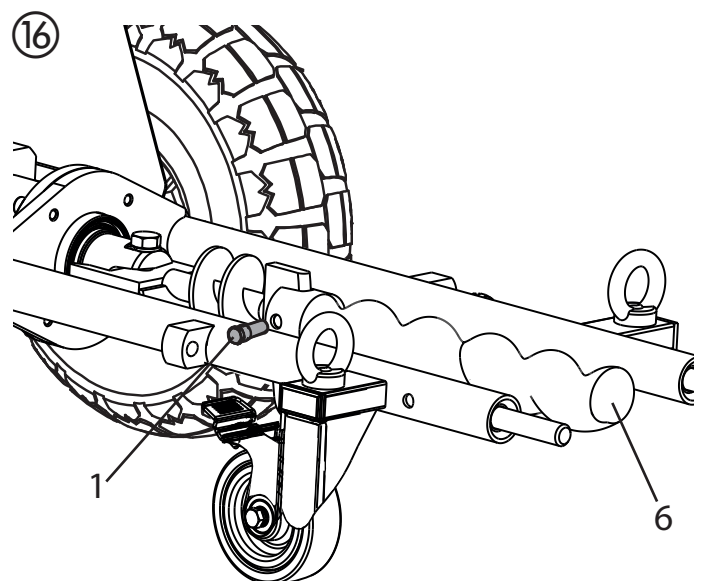

10 ELIMINATING FAULTS

MALFUNCTION	POSSIBLE CAUSE	ELIMINATION
Mortar spraying machine not running. Green operating light lights up	Delivery volume controller is set to „0“ Compressed air hose not connected or inadequate compressed air supply Air filter dirty (if fitted)	Increase delivery volume Check the compressed air hose and compressed air supply Clean the air filter
Mortar spraying machine not running. Green operating light does not light up	Power supply missing.	- Plug in the power plug. - Check the power cable for damage and replace, if necessary. - Check the power supply.
Mortar spraying machine not running. Red indicator light lights up (the number of flashes represents an error code)	Flash 3 times: Overcurrent Flash 4 times: Over voltage Flash 5 times: Under voltage Flash 6 times: Communication interruption Flash 7 times: Overheated Flash 8 times: Locked Continuous Flash with no stop: Communication interruption	- Check if the rotor/stator, gearbox or feeder shaft are stuck - Check power supply voltage - Check power supply voltage - Unlock the emergency stop switch and restart the machine. If the problem is not solved after performing it three times, please contact Wagner service or our designated distributors. - Shutdown the machine and check if the motor fan is faulty. If the fan is normal, wait until the controller has cooled down. Try to start the machine again. - If after switching on the machine three times it is still locked, please contact Wagner service or our designated distributors. - Please contact Wagner service or our designated distributors.
Mortar spraying machine cannot rotate the rotor	Rotor stuck in stator. Pump was not lubricated with pump sliding means.	Set the selector switch alternatively briefly to "F" (forwards) – "R" (reverse). Contact Wagner customer service if the problem cannot be resolved.
Mortar spraying machine builds up pressure in the mortar hose. However, coating material does not arrive at the spray lance.	Coating material "plug" in the mortar hose. Mortar hose not prerinsed with cellulose paste.	Depressurize the mortar hose – set the selector switch to "R" (reverse). Pump the coating material back into the container. <div data-bbox="922 1798 1066 1933">  </div> <div data-bbox="1082 1798 1487 1933"> <p>The mortar hose must be pressureless. Watch the manometer --> 0 bar. Wear safety goggles.</p> </div> Decouple mortar hose and rinse with water hose. When the plug has been removed, fill cellulose paste in the mortar hose. Couple the mortar hose back on.

MALFUNCTION	POSSIBLE CAUSE	ELIMINATION
Coating material is suddenly not emitted during spraying.	<p>Texture tip is clogged because of impurity in the coating material or because the granular size is too large.</p> <p>Texture tip too small.</p> <p>Coating material "plug" in the mortar hose. Mortar hose not prerinsed with cellulose paste.</p> <p>No coating material in the container. Pump has sucked in air.</p>	<p>Switch the mortar spraying machine off. Close the material cock at the spray lance. Remove the texture tip and clean it.</p> <p>Select a larger texture tip. Rule of thumb: Granular size x 3 → Tip size</p> <p>Depressurize the mortar hose – set the selector switch to "R" (reverse). Pump the coating material back into the container.</p> <div style="border: 1px solid black; padding: 5px; display: flex; align-items: center;">  <p>The mortar hose must be pressureless. Watch the manometer → 0 bar. Wear safety goggles.</p> </div> <p>Decouple mortar hose and rinse with water hose. When the plug has been removed, fill cellulose paste in the mortar hose. Couple the mortar hose back on.</p> <p>Refill the container with coating material and pump it around until the coating material emerges without any bubbles. Attention: Always top up with sufficient coating material. Do not let the pump run dry. Pump overheats, resulting in a danger of „plugs“.</p>
Spray pattern is not clean and even.	<p>Air ducts in the texture tip are partially closed with coating material.</p> <p>Air volume incorrectly set.</p> <p>Poor mortar spraying machine cleaning</p> <p>No coating material in the container. Pump has sucked in air.</p>	<p>Switch the mortar spraying machine off. Close the material tap at the spray lance. Remove the texture tip. Clean the air ducts of the texture tip.</p> <p>Change air volume setting.</p> <p>Thoroughly clean mortar spraying machine</p> <p>Refill the container with coating material and pump it around until the coating material emerges without any bubbles. Attention: Always top up with sufficient coating material. Do not let the pump run dry. Pump overheats, resulting in a danger of „plugs“.</p>

ELIMINATING FAULTS

MALFUNCTION	POSSIBLE CAUSE	ELIMINATION
Pressure at the manometer rises to more than 40 bars.	<p>Viscosity of the coating material too high. Mortar hose diameter too small.</p> <p>Mortar hose is too long.</p> <p>Coating material "plug" in the mortar hose. Mortar hose not prerinsed with cellulose paste.</p>	<p>Dilute the coating material.</p> <p>Use a mortar hose with a larger diameter.</p> <p>Use a shorter mortar hose.</p> <p>Depressurize the mortar hose – set the selector switch to "R" (reverse). Pump the coating material back into the container.</p> <div data-bbox="922 739 1489 878">  <p>The mortar hose must be pressureless. Watch the manometer --> 0 bar. Wear safety goggles.</p> </div> <p>Decouple mortar hose and rinse with water hose. When the plug has been removed, fill cellulose paste in the mortar hose. Couple the mortar hose back on.</p>
Mortar spraying machine does not pump enough coating material.	<p>Convey capacity selected too low.</p> <p>Mortar hose diameter too small.</p> <p>Stator worn.</p> <p>Texture tip too small.</p>	<p>Set the volume regulator higher.</p> <p>Use a mortar hose with a larger diameter.</p> <p>Mount a new stator, if necessary, also a new rotor. Attention: Spray on pump sliding means.</p> <p>Select a larger texture tip. Rule of thumb: Granular size x 3 --> Tip size</p>

If the defect is not caused by one of the above-mentioned faults, have the defect eliminated by the WAGNER customer service.

11 SPARE PARTS LIST FOR PC 1025PRO

ITEM	ORDER NO.	DESIGNATION	ITEM	ORDER NO.	DESIGNATION
1	3142039	Ring nut	10	348316	Rotor
2	2416820	Sealing, plaster coupling	11	2416814	Screw
3	2439516	Outlet unit cpl.	12	2416628	Feeder shaft
4	348315	Stator	13	2416632	Rubber seal, motor
	2416627	Rotor / Stator Kit (pos. 4,10,11)	14	9921501	Spring washer
5	2416813	Anti-twist lock for stator	15	9900313	Cylinder head screw
6	9900247	Hexagon head screw	16	2416629	Motor / Gear Unit
7	9921507	Spring washer	17	2416634	Pneumatic Controller, Set
8	2416633	Rubber seal, flange	18	2416408	Label PC 1025Pro
9	2436478	Receptacle			

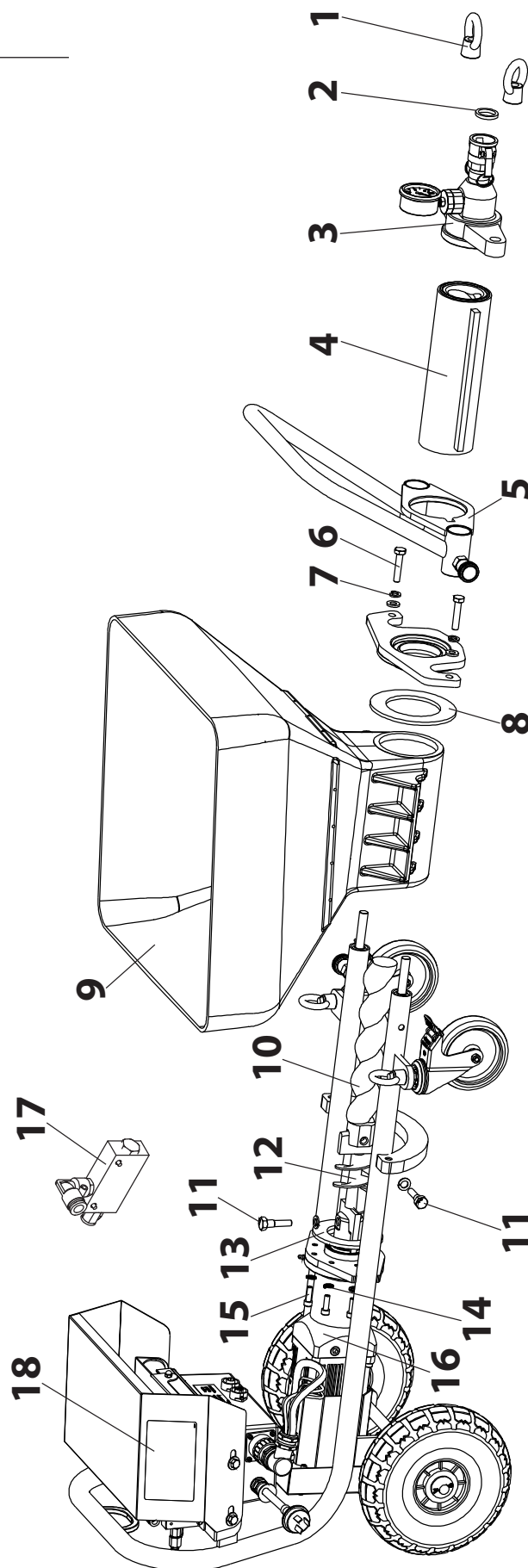



11.1 SPARE PARTS LIST FRAME

ITEM	ORDER NO.	DESIGNATION
1	2416991	Carriage
2	3142039	Ring nut M12
3	2416816	Guide pulley
4	2416631	Wheel

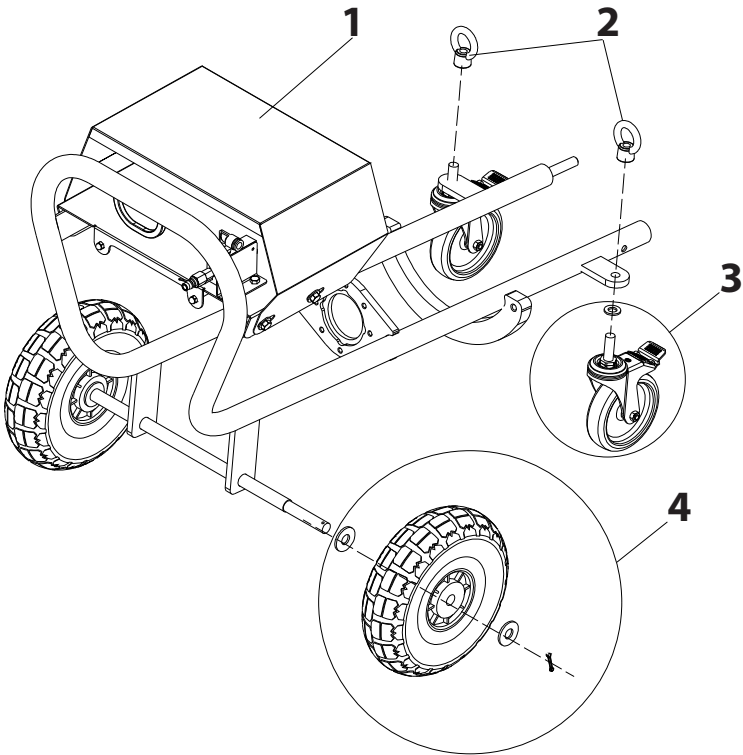

12 SPARE PARTS LIST – SPRAY LANCE

ITEM	PART NO.	DESIGNATION
	2438 213	Spray lance
1	2416 818	Union nut
2	2416 819	Sealing washer
3	2416 609	Texture tip 6 (standard)

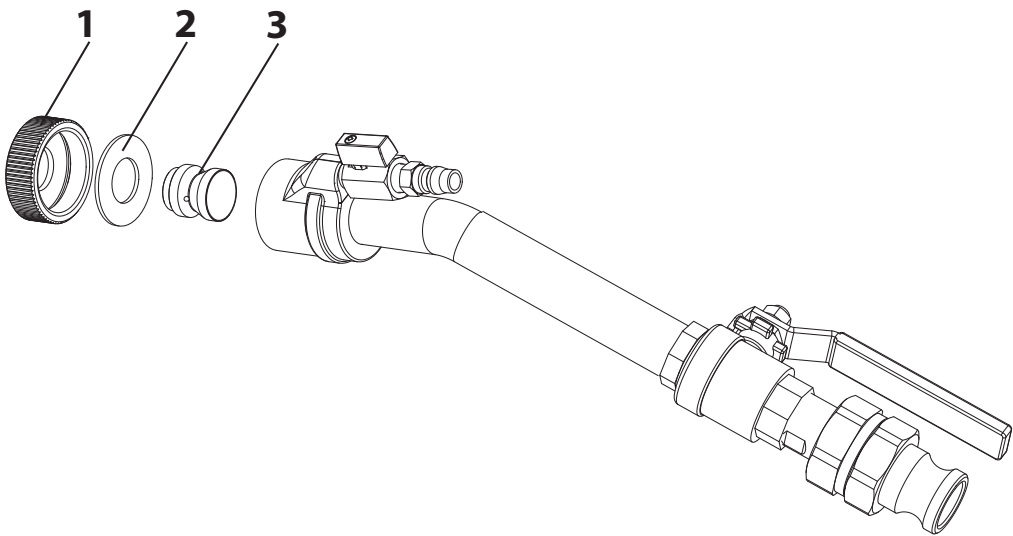

13 PC 1025 PRO ACCESSORIES

ITEM	PART NO.	DESIGNATION
1	2438 213	Spray lance (incl. texture tip 6)
2	Texture tips for automatic spray lance and ceiling spray lance:	
	2418 450	Texture tip 4
	2416 609	Texture tip 6 (standard)
	2416 610	Texture tip 8
	2416 611	Texture tip 10
	2416 612	Texture tip 12
3	2416 809	Mortar hose DN 19 – 6 m (standard)
	2396 956	Mortar hose DN 25 – 10 m
4	2416 820	Fix coupling seal M 27
5	0342 916	Cleaning needle
6	0342 330	Cleaning ball for DN 19
	0342 331	Cleaning ball for DN 27
7	9992 824	Pump sliding means 500 ml
8	0342 241	Cleaning adapter M 27 – GK
	0348 948	Cleaning adapter M 35 – GK
9	2312 136	Lubricant for mortar hose (Metylan wallpaper paste) 125g (no picture)
10	2417014	Air filter
11	348316	Rotor (10 litre)
	34892	Rotor (15 litre)
	2385520	Rotor (20 litre)
12	348315	Stator (10 litre)
	348925	Stator (15 litre)
	2385532	Stator (20 litre)
13	2416627	Rotor / Stator Kit (10 litre)

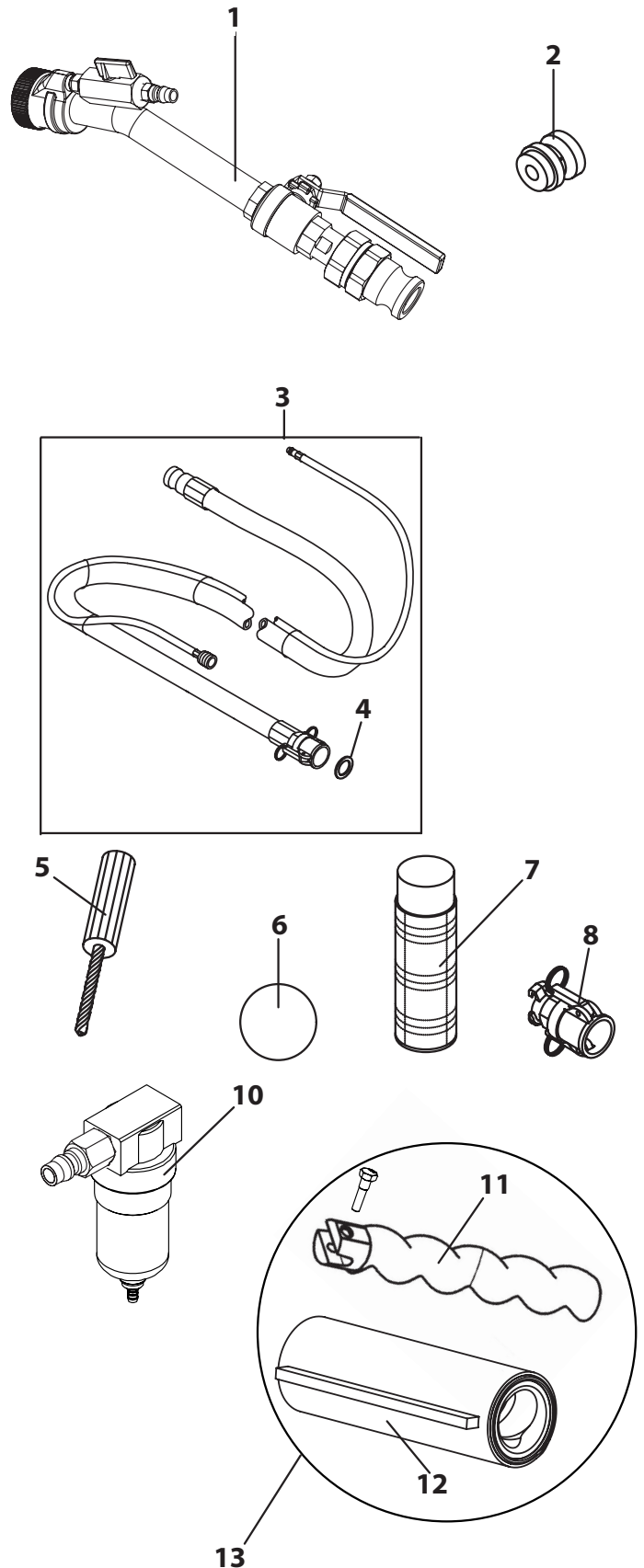

TESTING OF THE UNIT

For safety reasons, we would recommend having the device checked by an expert as required but at least every 12 months to ensure that it can continue to operate safely.

In the case of unused devices, the check can be postponed until they are next started up.

All (potentially deviating) national inspection and maintenance regulations must also be observed.

If you have any questions, please contact the customer service team at Wagner.

IMPORTANT INFORMATION ON PRODUCT LIABILITY

According to an EU directive, the manufacturer is only liable without limitation for faults in the product if all parts come from the manufacturer or have been approved by the manufacturer and have been mounted to the device and are operated properly. If third-party accessories or spare parts are used, the manufacturer is exonerated wholly or partly from his/her liability if use of the third-party accessories or spare parts have caused a defect in the product. In extreme cases, the relevant authorities can completely prohibit using the entire device.

With original WAGNER accessories and spare parts, compliance with all safety regulations is guaranteed.

NOTE ON DISPOSAL

In observance of the European Directive 2012/19/EU on waste electrical and electronic equipment and implementation in accordance with national law, this product is not to be disposed of together with household waste material but must be recycled in an environmentally friendly way!



Wagner or one of our dealers will take back your used Wagner waste electrical or electronic equipment and will dispose of it for you in an environmentally friendly way. Please ask your local Wagner service centre or dealer for details or contact us direct.

WAGNER STANDARD GUARANTEE

(EFFECTIVE FROM FEBRUARY 1, 2022)

This warranty only applies to all products purchased from WAGNER and its authorised dealers after February 1, 2022.

STANDARD GUARANTEE TERMS & CONDITIONS

1. Scope of guarantee

All WAGNER building painting equipment (hereinafter referred to as "Products") are inspected, tested and accepted in accordance with WAGNER's guarantee requirements. WAGNER provides this guarantee only to customers who have purchased products from our authorised dealers.

This guarantee does not affect the buyer's statutory right to claim or demand compensation from the seller for product defects under the purchase contract.

The product or part is replaced or repaired at the discretion of WAGNER, and the replaced product or part is owned by us.

2. Guarantee period and registration

The standard guarantee period is as follows:

- 12 months for the following models:
HVLV/XVLP series, Diaphragm Pump SF series, Piston Pump PS series, Screw Pump PC series, Hydraulic Piston Pump HC series, Pneumatic Pump
- The guarantee period will be cut in half if the product is used for industrial use or for applications with an equivalent amount of wear and tear, such as for continuous work or renting out.

Definition of guarantee period: from the date of delivery to the customer from WAGNER and Wagner's authorised dealer (refer to the date on the original proof of purchase).

When claiming on the guarantee, the customer shall provide the original proof of purchase, including the invoice, receipt, transfer voucher, payment voucher, and other authoritative documents.

The right to the guarantee is only for the first? buyer of the equipment and shall not be transferred. The guarantee period of spare parts replaced within the guarantee period shall still continue from the date that the equipment was purchased. If the guarantee period of the equipment expires, the guarantee period of the spare parts replaced by Wagner's authorised agent or WAGNER itself shall be 90 days from the date of the replacement.

3. Guarantee procedure

If the equipment is found to be defective in performance during the guarantee period, the buyer shall immediately claim on the guarantee.

Remarks: The buyer, after receiving the equipment, shall immediately inspect the equipment thoroughly, and, within 14 days from the date of receiving the equipment, contact (1) Wagner's authorised dealer, or (2) WAGNER, submit the guarantee claim, and, at the same time, provide relevant information to effectively protect their guarantee rights.

Address of Wagner Technical Support and Service Centre:

J. Wagner GmbH
Otto-Lilienthal-Straße 18
D-88677 Markdorf
Germany

Technical Support and Service Hotline:

+49 / 75 44 / 505-1520

email: Technical.Support-DF@wagner-group.com

Customer Service Hotline:

+49 / 75 44 / 505-1666

email: kundenzentrum@wagner-group.com

The product and the original purchase document indicating the purchase date, name, and serial number shall be delivered for repair, with transportation costs paid by the customer.

The costs for delivery to the repair centre or back to the customer and the risk of product loss or damage shall be borne by the customer.

4. Exclusion of guarantee

Standard guarantee claims cannot be considered

- for parts that are subject to wear and tear due to use or other natural wear and tear, as well as defects in the product that are a result of natural wear and tear, or wear and tear due to use. This includes in particular cables, valves, packaging, jets, cylinders, pistons, fluid wetted parts, filters, pipes, seals, rotors, stators, tips, etc. Damage due to wear and tear that is caused in particular by sanded coating materials, such as dispersions, plaster, putty, adhesives, glazes, quartz foundation.
- for the clutch assembly on a gas sprayer or striper.
- in the event of errors in devices that are due to non-compliance with the operating instructions, unsuitable or unprofessional use, incorrect assembly and/or commissioning by the buyer or by a third party, or utilization other than is intended, abnormal ambient conditions, unsuitable coating materials, unsuitable operating conditions, operation with the incorrect mains voltage supply/frequency, over operation or defective servicing or care and/or cleaning.
- for errors in the device that have been caused by using accessory parts, additional components or spare parts that are not original WAGNER parts.

- for products to which modifications or additions have been carried out.
- for products where the serial number has been removed or is illegible.
- for products to which attempts at repairs have been carried out by unauthorized persons.
- for products with slight deviations from the target properties, which are negligible with regard to the value and usability of the device.
- for products that have been partially or fully taken apart.

5. Additional regulations.

If the check shows that the case is not a guarantee case, repairs are carried out at the expense of the buyer.

The above regulations manage the legal relationship to us with reference to WAGNER Standard Guarantee.

Any additional claims, in particular for damages and losses of any type, which occur as a result of the customer's improper use of our products, are excluded from our product liability, unless otherwise stipulated by law or regulations. In addition, any claims for any losses, which are not caused directly from the products or the use of the products are also excluded from our product liability, unless otherwise stipulated by law or regulations.

Claims for liability for defects to the distributors remain unaffected.

The contractual language is English. In the event that the meaning of the English and a foreign text of this guarantee deviate from one another, the meaning of the English text has priority. WAGNER Decorative Finishing reserves the right of final explanation.

Subject to modifications



WAGNER SPRAYTECH(SHANGHAI) CO., LTD.

Division Professional Finishing

Flr 1, Building 10, No 58, 3 rd Jiangchang Rd
Shanghai 200436
China

J. WAGNER GMBH

Otto-Lilienthal-Str. 18

88677 Markdorf

T +49 0180 - 55 92 46 37

hotline@wagner-group.com